



CAINTON

Change is a perpetual motion

EC Centrifugal Fan & Blower

- Code Rule - p.1
- EC Backward Centrifugal Fan - pp. 2 -65
- EC Forward Centrifugal Fan - pp. 66 - 81
- EC Single & Double Inlet Blower - pp. 82 - 111

Code Rule

Fan Type	Fan imension (mm)		Voltage	Speed	Connection	Function	Mold Model	IP Level
CTE: EC Backward Centrifugal Fan	Diameter of Impeller	Thickness	V1: 115VAC	HX: Higher than Extreme	C: Connector	N1: FG	-Mold Model	-IP Level
CTFE: EC Forward Centrifugal Fan	Diameter of Impeller	Thickness	V2: 230VAC	XH: Extremely High		N2: RD		
CTBE: EC Single & Double Inlet Blower	Diameter of Impeller	Length	V3: 380VAC	HH: Much Higher		N3: PWM		
			V4: 440VAC	HR: Higher		N4: Voltage Control		
			FV: Full Voltage	H: High		N5: FG+PWM		
				M: Medium		N6: RD+PWM		
				L: Low		N7: FG+VC		
				LR: Lower		N8: RD+VC		
				LW: Much Lower				
				XL: Extremely Low				
				LX: Lower than Extreme				

EC Backward Centrifugal Fan

Ø133x110mm

- Impeller: Plastic PA66+GF
- Protection: IP44
- Insulation: Class B
- Certification: CE, RoHS
- Additional functions are optional



Model	Voltage	Frequency	Current	Power	Speed	Max Air Flow	Max Pressure	Noise
	VAC	Hz	Amp	Watt	RPM	M3/H	Pa	dB(A)
CTE133110V2HR-M	230	50/60	0.33	48	4480	460	475	75

EC Backward Centrifugal Fan

Ø133x110mm

- Dimension: Unit: mm

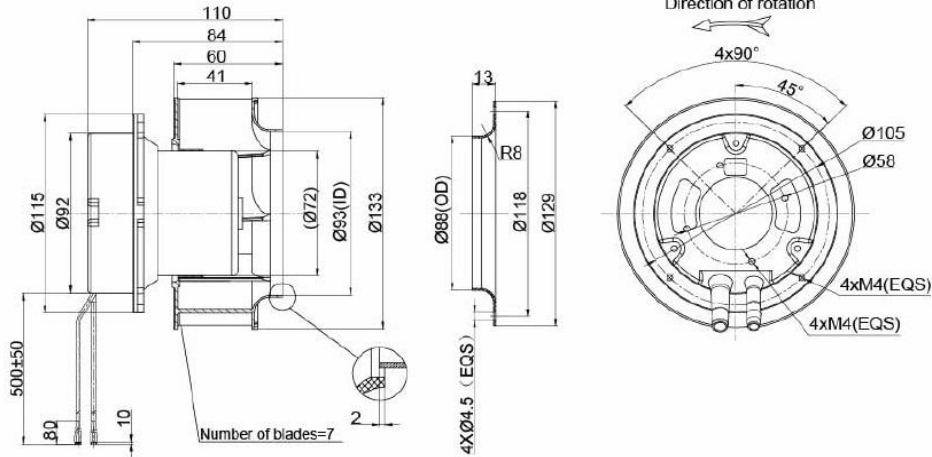

- Performance:

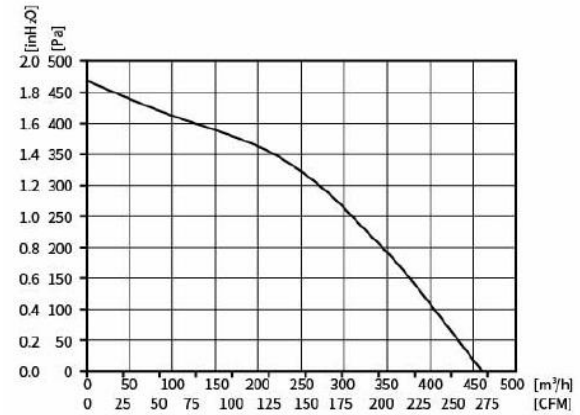

EC Backward Centrifugal Fan

Ø175x95mm

- Impeller: Plastic PA66+GF
- Protection: IP44
- Insulation: Class B
- Certification: CE, RoHS
- Additional functions are optional



Model	Voltage	Frequency	Current	Power	Speed	Max Air Flow	Max Pressure	Noise
	VAC	Hz	Amp	Watt	RPM	M3/H	Pa	dB(A)
CTE17595V2HR-M	230	50/60	0.85	105	4460	810	744	76

EC Backward Centrifugal Fan

Ø175x95mm

- Dimension:
Unit: mm

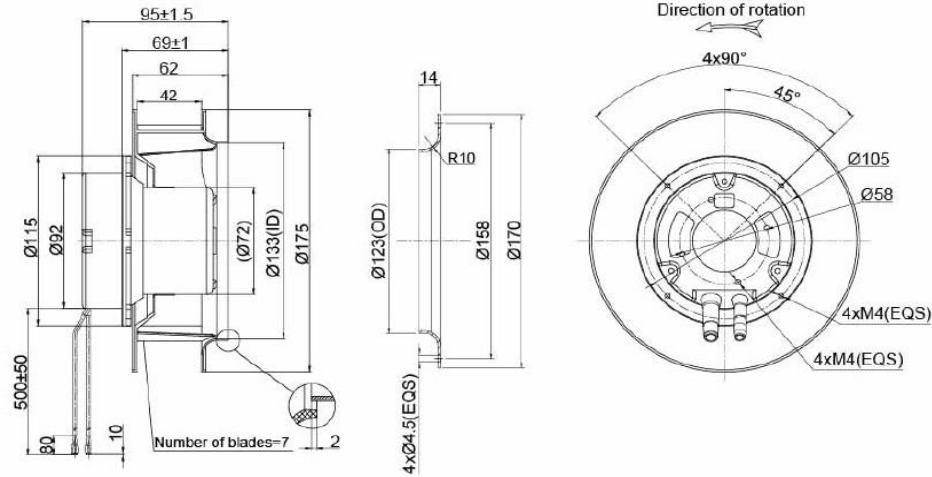

- Performance:

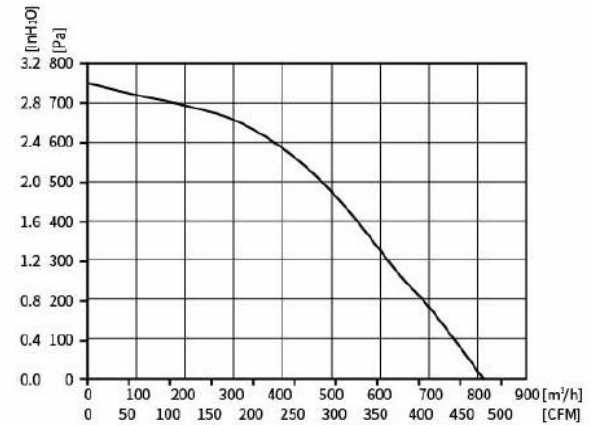

EC Backward Centrifugal Fan

Ø190x95mm

- Impeller: Plastic PA66+GF
- Protection: IP44
- Insulation: Class B
- Certification: CE, RoHS
- Additional functions are optional



Model	Voltage	Frequency	Current	Power	Speed	Max Air Flow	Max Pressure	Noise
	VAC	Hz	Amp	Watt	RPM	M3/H	Pa	dB(A)
CTE19095V2H-M	230	50/60	0.7	93	3570	795	686	72

EC Backward Centrifugal Fan

Ø190x95mm

- Dimension:
Unit: mm

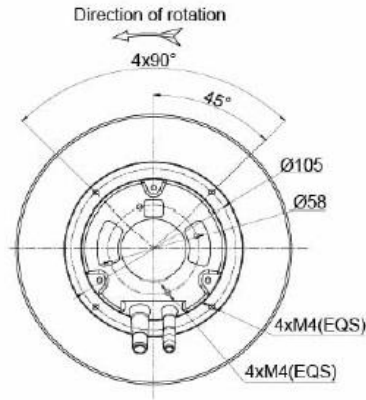
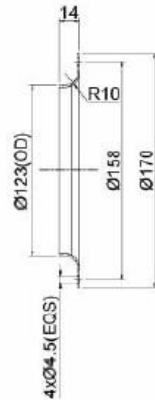
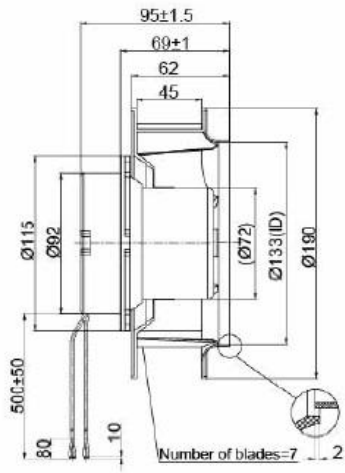

- Performance:

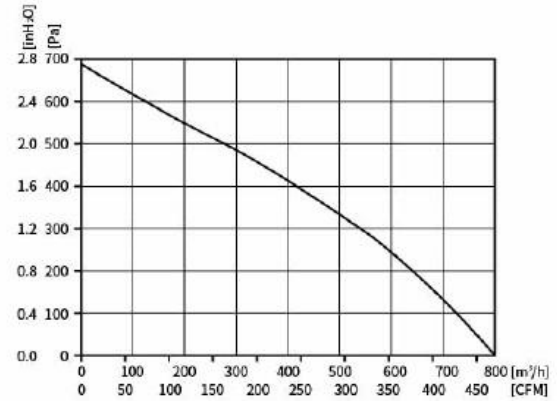

EC Backward Centrifugal Fan

Ø190x95mm - B Type

- Impeller: Plastic PA66+GF
- Protection: IP44
- Insulation: Class B
- Certification: CE, RoHS
- Additional functions are optional



Model	Voltage	Frequency	Current	Power	Speed	Max Air Flow	Max Pressure	Noise
	VAC	Hz	Amp	Watt	RPM	M3/H	Pa	dB(A)
CTE19095V2HR-M2	230	50/60	1	140	4000	800	882	74

EC Backward Centrifugal Fan

Ø190x95mm - B Type

- Dimension:
Unit: mm

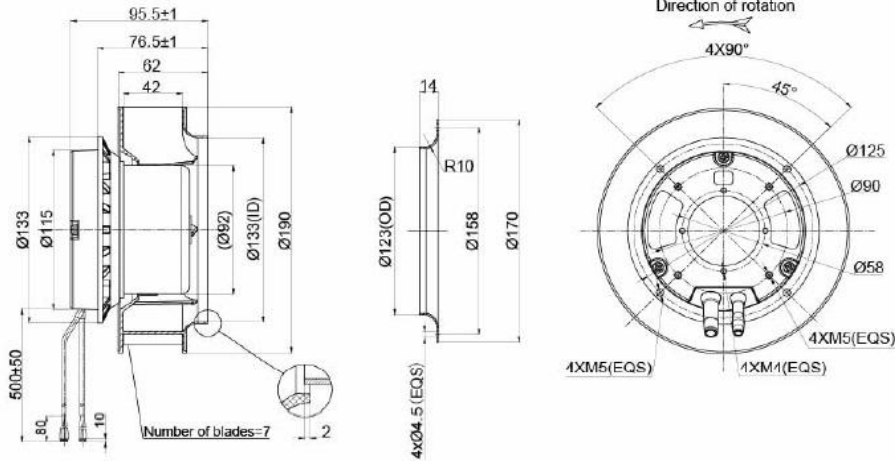

- Performance:

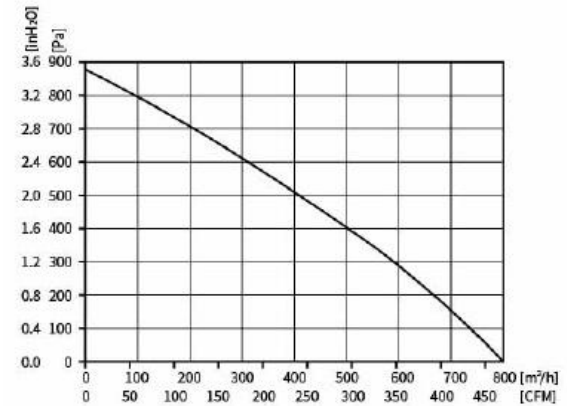

EC Backward Centrifugal Fan

Ø220x97mm

- Impeller: Plastic PA66+GF
- Protection: IP44
- Insulation: Class B
- Certification: CE, RoHS
- Additional functions are optional



Model	Voltage	Frequency	Current	Power	Speed	Max Air Flow	Max Pressure	Noise
	VAC	Hz	Amp	Watt	RPM	M3/H	Pa	dB(A)
CTE22097V2H-M	230	50/60	0.8	95	3060	1080	648	71

EC Backward Centrifugal Fan

Ø220x97mm

- Dimension:

Unit: mm

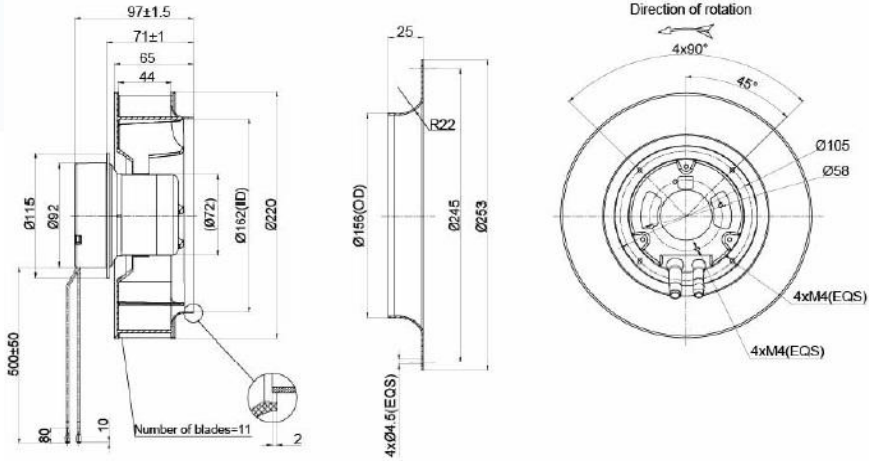

- Performance:

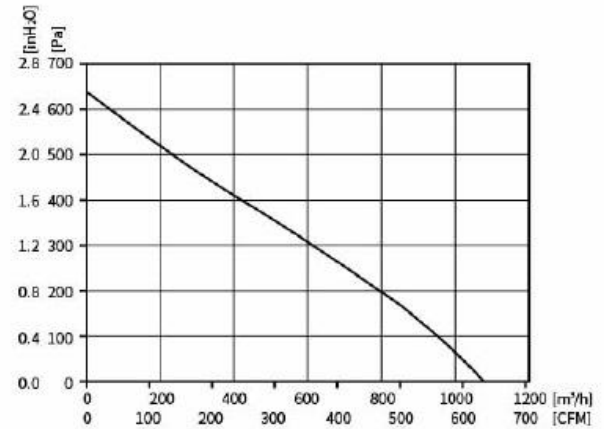

EC Backward Centrifugal Fan

Ø220x93mm

- Impeller: Plastic PA66+GF
- Protection: IP44
- Insulation: Class B
- Certification: CE, RoHS
- Additional functions are optional



Model	Voltage	Frequency	Current	Power	Speed	Max Air Flow	Max Pressure	Noise
	VAC	Hz	Amp	Watt	RPM	M3/H	Pa	dB(A)
CTE22093V2H-M	230	50/60	1.18	170	3600	1100	840	76

EC Backward Centrifugal Fan

Ø225x125mm

- Impeller: Plastic PA66+GF
- Protection: IP44
- Insulation: Class B
- Certification: CE, RoHS
- Additional functions are optional



Model	Voltage	Frequency	Current	Power	Speed	Max Air Flow	Max Pressure	Noise
	VAC	Hz	Amp	Watt	RPM	M3/H	Pa	dB(A)
CTE225125V2M-M	230	50/60	0.4	55	2200	1065	347	66

EC Backward Centrifugal Fan

Ø225x125mm

- Dimension:
Unit: mm

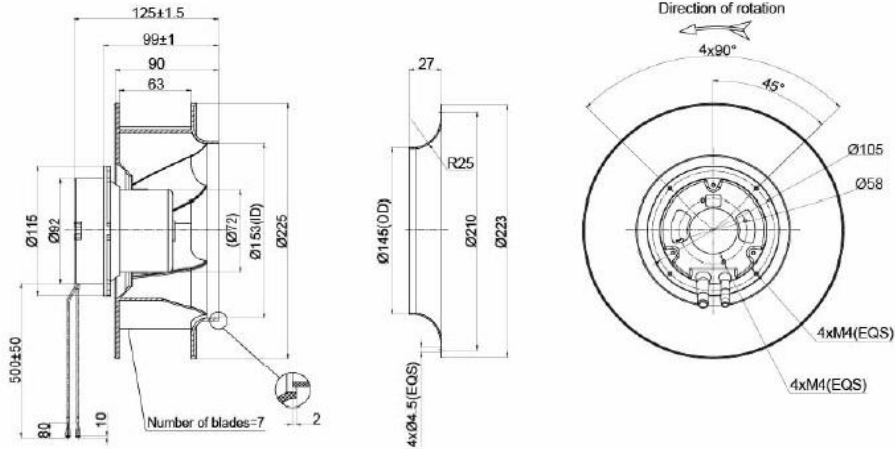

- Performance:

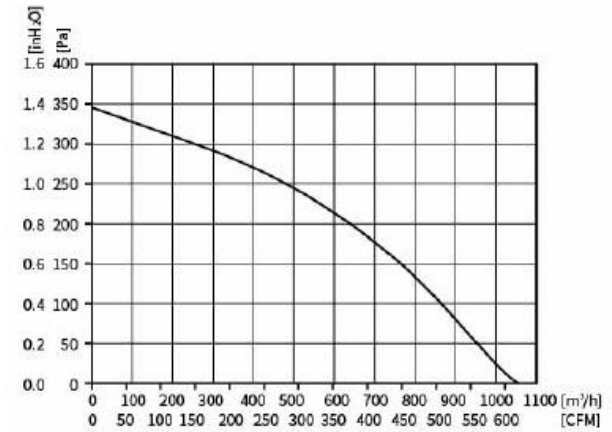

EC Backward Centrifugal Fan

Ø225x123mm

- Impeller: Plastic PA66+GF
- Protection: IP44
- Insulation: Class B
- Certification: CE, RoHS
- Additional functions are optional



Model	Voltage	Frequency	Current	Power	Speed	Max Air Flow	Max Pressure	Noise
	VAC	Hz	Amp	Watt	RPM	M3/H	Pa	dB(A)
CTE225123V2H-M	230	50/60	1.04	135	3020	1340	705	71

EC Backward Centrifugal Fan

Ø225x123mm

- Dimension:

Unit: mm

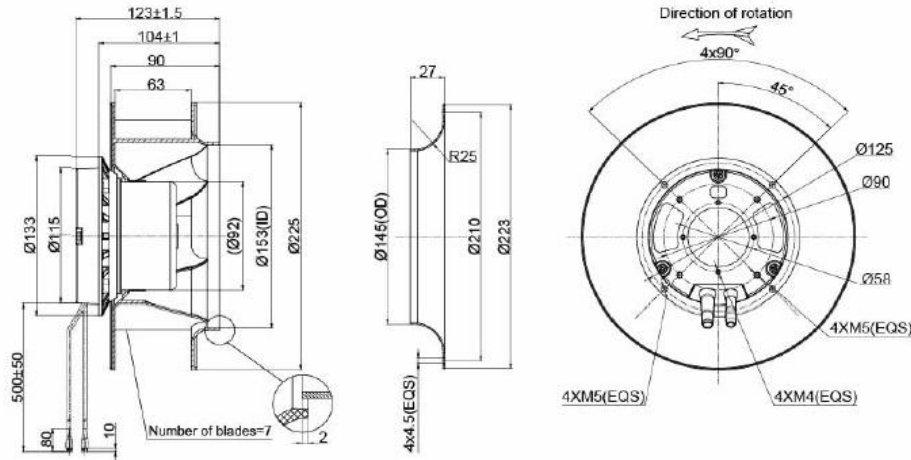

- Performance:

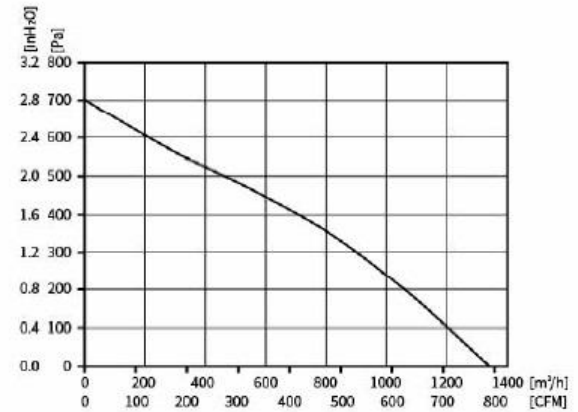

EC Backward Centrifugal Fan

Ø250x111mm

- Impeller: Plastic PA66+GF
- Protection: IP44
- Insulation: Class B
- Certification: CE, RoHS
- Additional functions are optional



Model	Voltage	Frequency	Current	Power	Speed	Max Air Flow	Max Pressure	Noise
	VAC	Hz	Amp	Watt	RPM	M3/H	Pa	dB(A)
CTE250111V2M-M	230	50/60	0.9	123	2760	1290	690	71

EC Backward Centrifugal Fan

Ø250x111mm

- Dimension:
Unit: mm

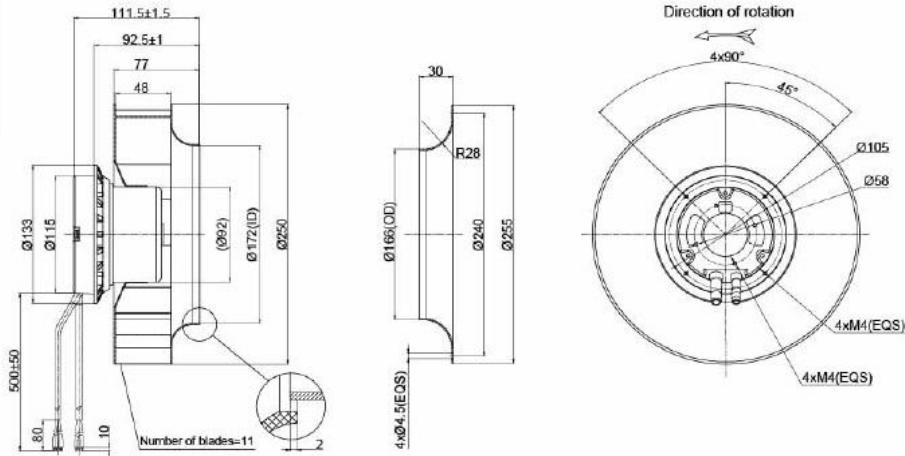

- Performance:

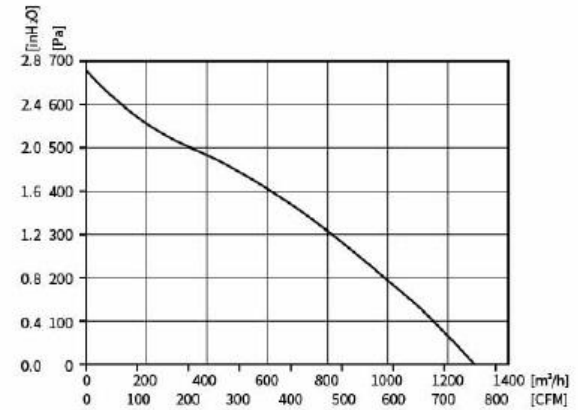

EC Backward Centrifugal Fan

Ø250x118mm

- Impeller: Metal Sheet
- Protection: IP44
- Insulation: Class B
- Certification: CE, RoHS
- Additional functions are optional



Model	Voltage	Frequency	Current	Power	Speed	Max Air Flow	Max Pressure	Noise
	VAC	Hz	Amp	Watt	RPM	M3/H	Pa	dB(A)
CTE250118V2M-M	230	50/60	1.13	155	2780	1700	716	75

EC Backward Centrifugal Fan

Ø250x118mm

- Dimension:

Unit: mm

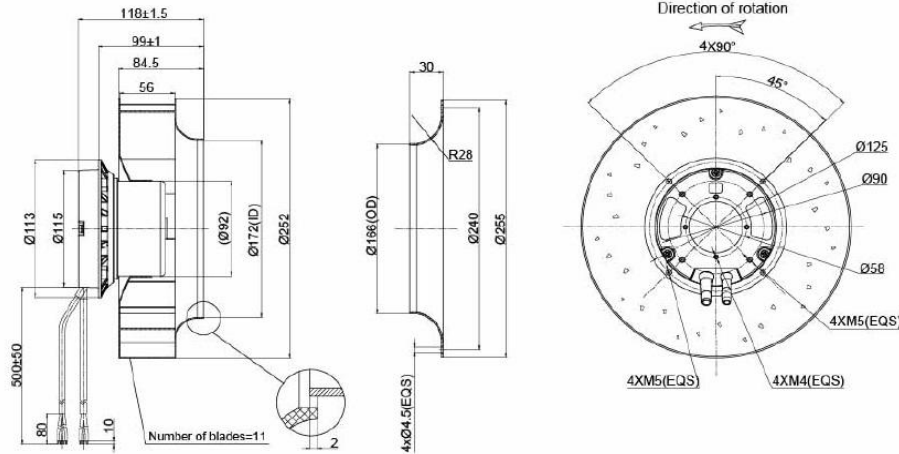

- Performance:

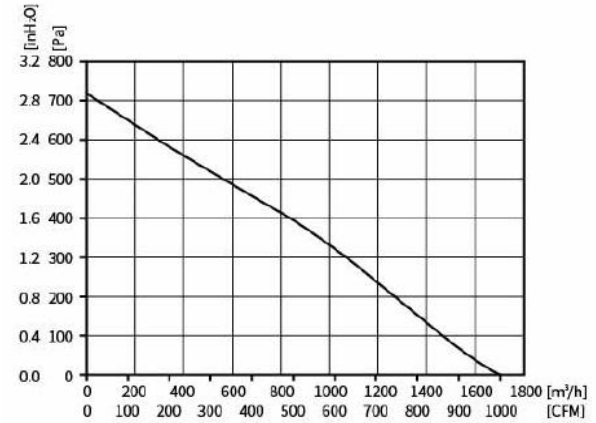

EC Backward Centrifugal Fan

Ø250x157mm

- Impeller: Metal Sheet
- Protection: IP44
- Insulation: Class B
- Certification: CE, RoHS
- Additional functions are optional



Model	Voltage	Frequency	Current	Power	Speed	Max Air Flow	Max Pressure	Noise
	VAC	Hz	Amp	Watt	RPM	M3/H	Pa	dB(A)
CTE250157V2H-M	230	50/60	1.72	387	3550	2060	1030	80

EC Backward Centrifugal Fan

Ø250x157mm

- Dimension:
Unit: mm

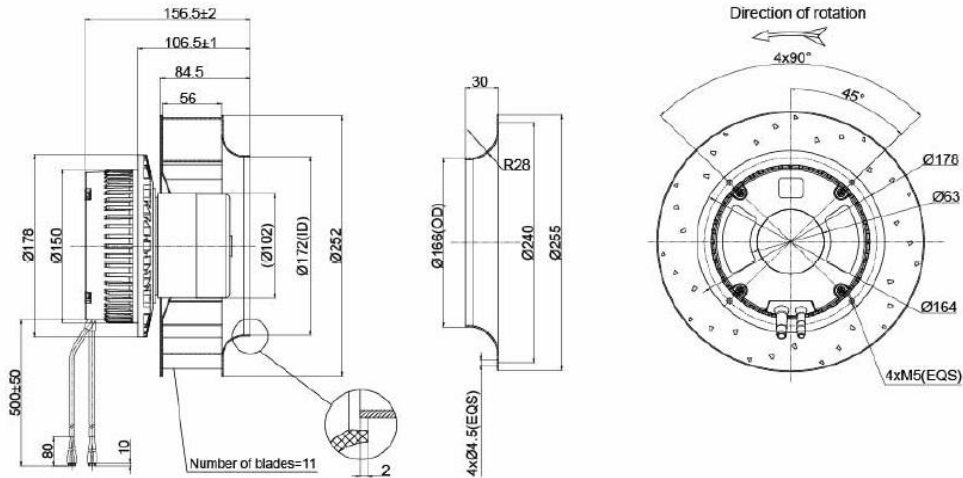

- Performance:

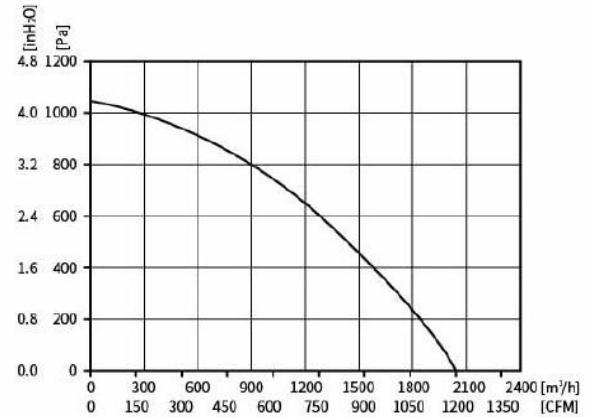

EC Backward Centrifugal Fan

Ø280x115mm

- Impeller: Metal Sheet
- Protection: IP44
- Insulation: Class B
- Certification: CE, RoHS
- Additional functions are optional



Model	Voltage	Frequency	Current	Power	Speed	Max Air Flow	Max Pressure	Noise
	VAC	Hz	Amp	Watt	RPM	M3/H	Pa	dB(A)
CTE280115V2M-M	230	50/60	1.7	230	2700	1930	740	74

EC Backward Centrifugal Fan

Ø280x144mm

- Impeller: Metal Sheet
- Protection: IP44
- Insulation: Class B
- Certification: CE, RoHS
- Additional functions are optional



Model	Voltage	Frequency	Current	Power	Speed	Max Air Flow	Max Pressure	Noise
	VAC	Hz	Amp	Watt	RPM	M3/H	Pa	dB(A)
CTE280144V2M-M	230	50/60	0.9	120	2000	2100	460	72

EC Backward Centrifugal Fan

Ø280x144mm

- Dimension:
Unit: mm

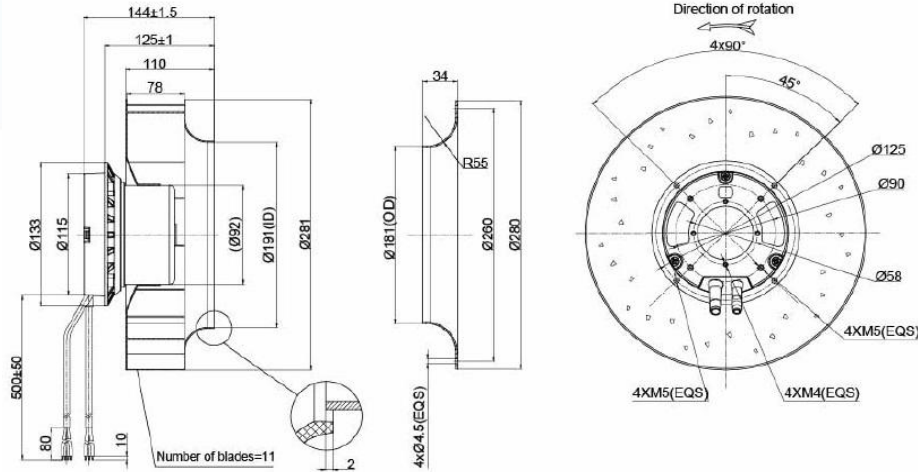

- Performance:

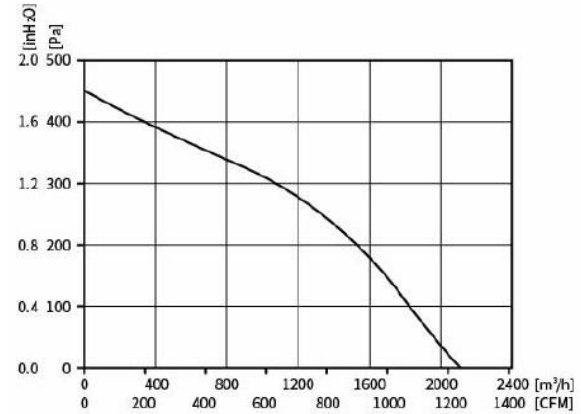

EC Backward Centrifugal Fan

Ø280x173mm

- Impeller: Metal Sheet
- Protection: IP44
- Insulation: Class B
- Certification: CE, RoHS
- Additional functions are optional



Model	Voltage	Frequency	Current	Power	Speed	Max Air Flow	Max Pressure	Noise
	VAC	Hz	Amp	Watt	RPM	M3/H	Pa	dB(A)
CTE280173V2M-M	230	50/60	1.75	390	2760	2800	895	80

EC Backward Centrifugal Fan

Ø280x173mm

- Dimension:
Unit: mm

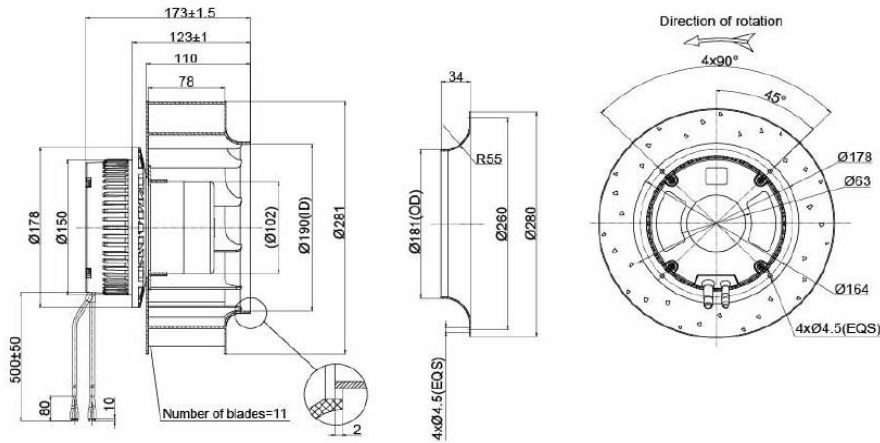

- Performance:

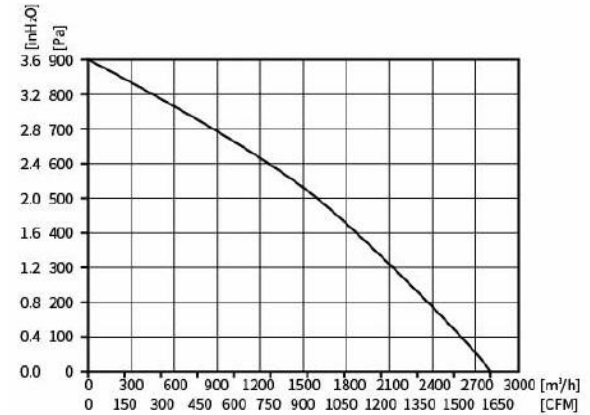

EC Backward Centrifugal Fan

Ø280x225mm

- Impeller: Metal Sheet
- Protection: IP44
- Insulation: Class B
- Certification: CE, RoHS
- Additional functions are optional



Model	Voltage	Frequency	Current	Power	Speed	Max Air Flow	Max Pressure	Noise
	VAC	Hz	Amp	Watt	RPM	M3/H	Pa	dB(A)
CTE280225V3M-M	380	50/60	1.1	780	2850	2950	1000	82

EC Backward Centrifugal Fan

Ø280x225mm

- Dimension:

Unit: mm

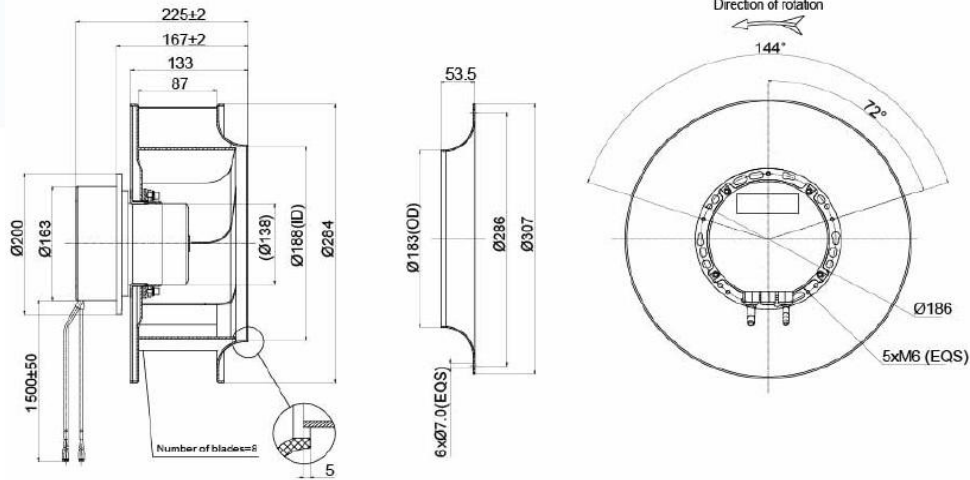

- Performance:

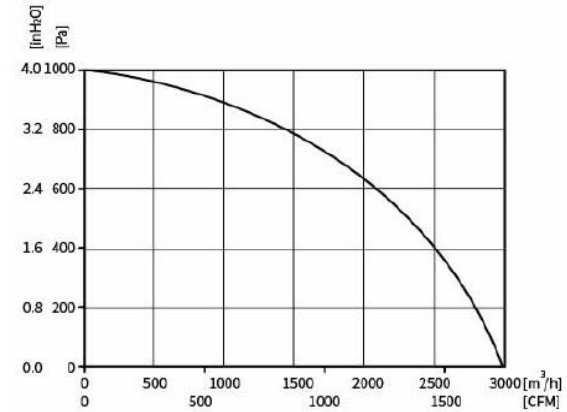

EC Backward Centrifugal Fan

Ø310x139mm

- Impeller: Metal Sheet
- Protection: IP44
- Insulation: Class B
- Certification: CE, RoHS
- Additional functions are optional



Model	Voltage	Frequency	Current	Power	Speed	Max Air Flow	Max Pressure	Noise
	VAC	Hz	Amp	Watt	RPM	M3/H	Pa	dB(A)
CTE310139V2M-M	230	50/60	1.15	167	2050	2310	640	68

EC Backward Centrifugal Fan

Ø310x139mm

- Dimension:

Unit: mm

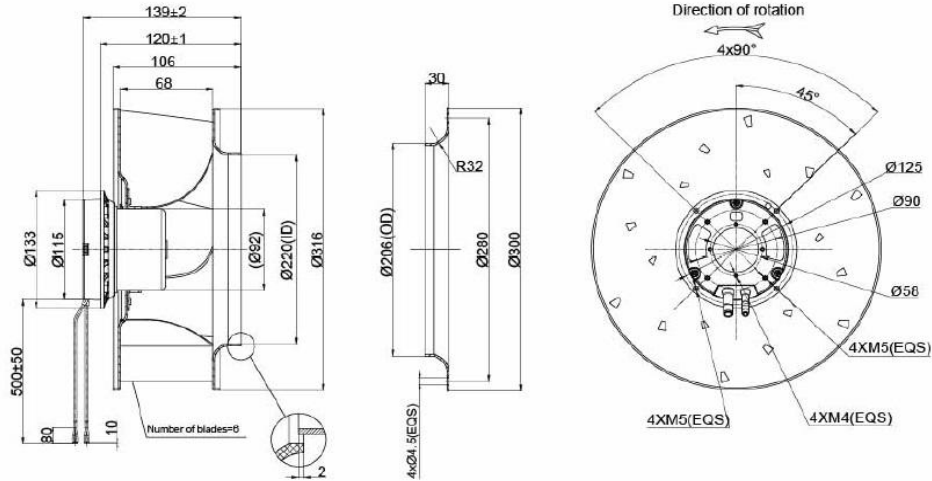

- Performance:

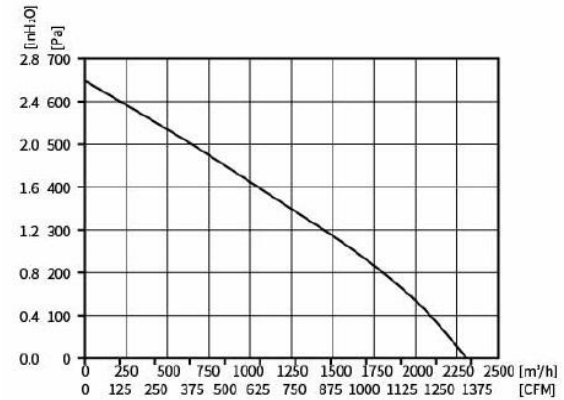

EC Backward Centrifugal Fan

Ø310x170mm

- Impeller: Metal Sheet
- Protection: IP44
- Insulation: Class B
- Certification: CE, RoHS
- Additional functions are optional



Model	Voltage	Frequency	Current	Power	Speed	Max Air Flow	Max Pressure	Noise
	VAC	Hz	Amp	Watt	RPM	M3/H	Pa	dB(A)
CTE310170V2M-M	230	50/60	1.8	420	2680	2740	992	78

EC Backward Centrifugal Fan

Ø310x170mm

- Dimension:
Unit: mm

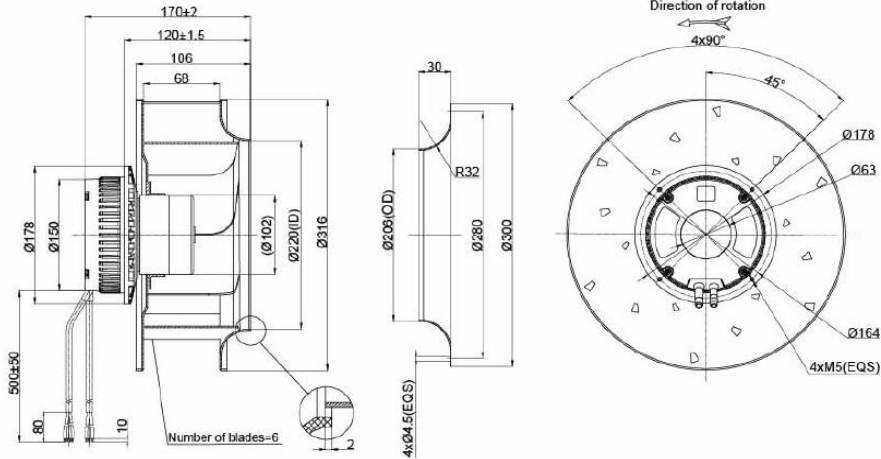

- Performance:

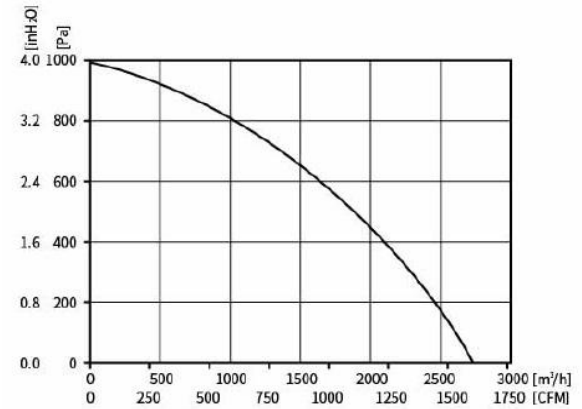

EC Backward Centrifugal Fan

Ø310x173mm

- Impeller: Metal Sheet
- Protection: IP44
- Insulation: Class B
- Certification: CE, RoHS
- Additional functions are optional



Model	Voltage	Frequency	Current	Power	Speed	Max Air Flow	Max Pressure	Noise
	VAC	Hz	Amp	Watt	RPM	M3/H	Pa	dB(A)
CTE310173V2L-M	230	50/60	0.95	135	1630	2300	394	64

EC Backward Centrifugal Fan

Ø310x173mm

- Dimension:

Unit: mm

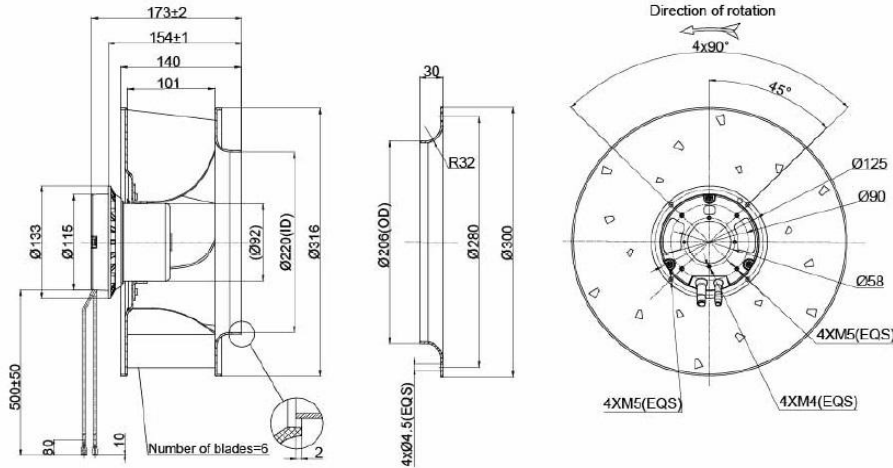

- Performance:

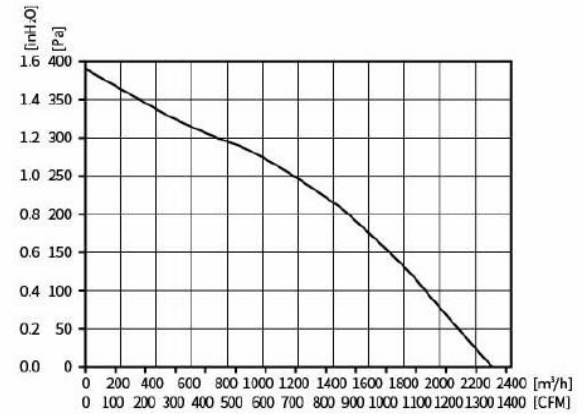

EC Backward Centrifugal Fan

Ø310x238mm

- Impeller: Metal Sheet
- Protection: IP44
- Insulation: Class B
- Certification: CE, RoHS
- Additional functions are optional



Model	Voltage	Frequency	Current	Power	Speed	Max Air Flow	Max Pressure	Noise
	VAC	Hz	Amp	Watt	RPM	M3/H	Pa	dB(A)
CTE310238V3M-M	380	50/60	1.64	980	2600	4300	1000	74

EC Backward Centrifugal Fan

Ø310x238mm

- Dimension:

Unit: mm

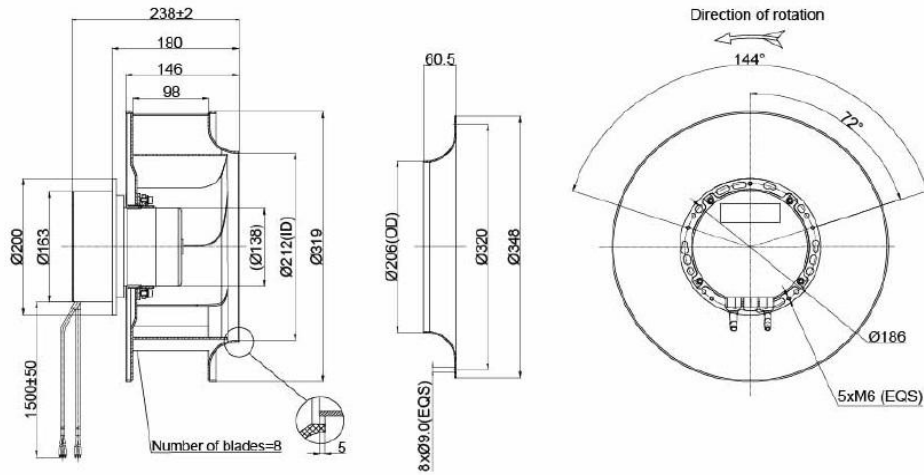

- Performance:

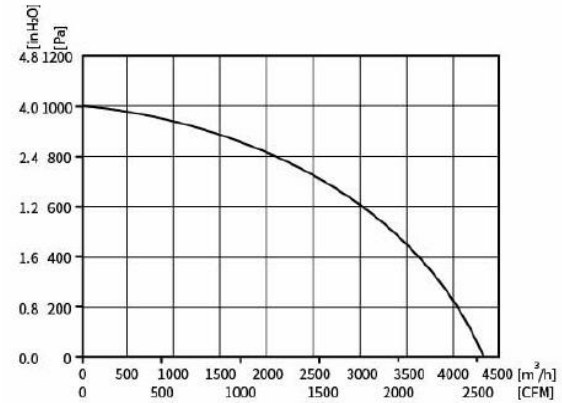

EC Backward Centrifugal Fan

Ø310x202mm

- Impeller: Metal Sheet
- Protection: IP44
- Insulation: Class B
- Certification: CE, RoHS
- Additional functions are optional



Model	Voltage	Frequency	Current	Power	Speed	Max Air Flow	Max Pressure	Noise
	VAC	Hz	Amp	Watt	RPM	M3/H	Pa	dB(A)
CTE310202V2M-M	230	50/60	1.5	350	2300	2690	660	73

EC Backward Centrifugal Fan

Ø310x202mm

- Dimension:
Unit: mm

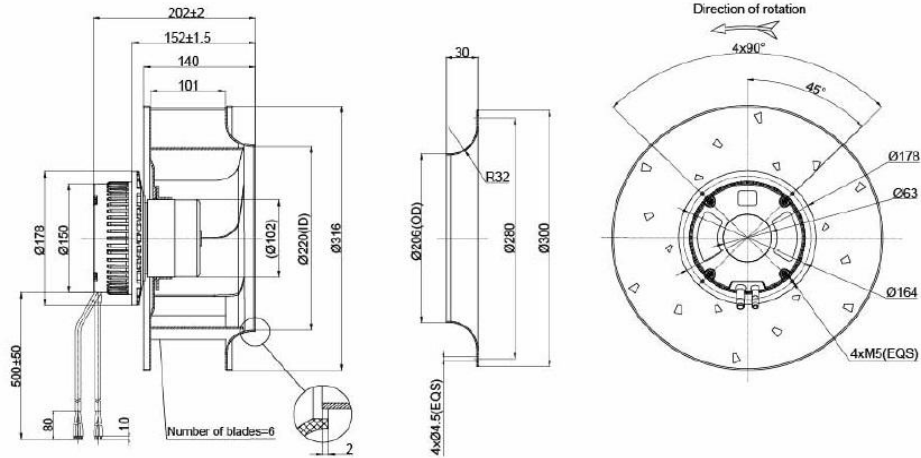

- Performance:

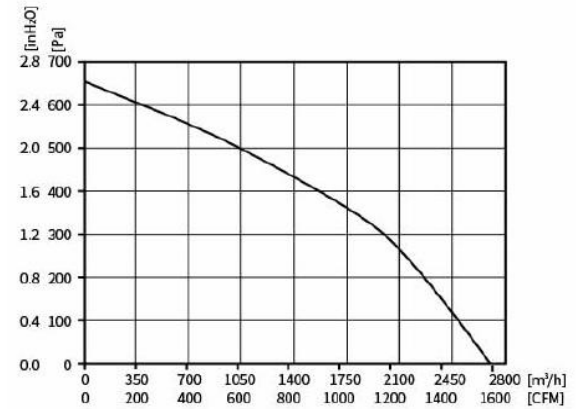

EC Backward Centrifugal Fan

Ø355x209mm

- Impeller: Metal Sheet
- Protection: IP44
- Insulation: Class B
- Certification: CE, RoHS
- Additional functions are optional



Model	Voltage	Frequency	Current	Power	Speed	Max Air Flow	Max Pressure	Noise
	VAC	Hz	Amp	Watt	RPM	M3/H	Pa	dB(A)
CTE355209V2M-M	230	50/60	1.6	357	2050	3270	820	76

EC Backward Centrifugal Fan

Ø355x209mm

- Dimension:

Unit: mm

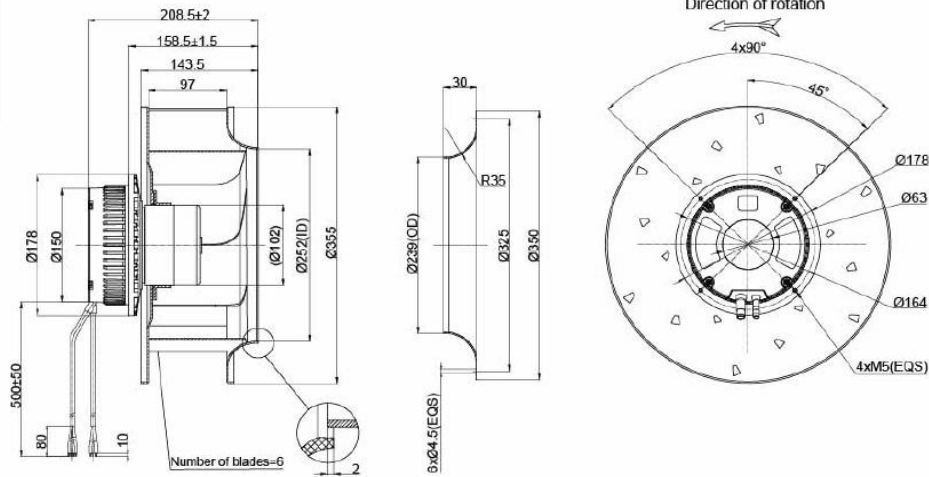

- Performance:

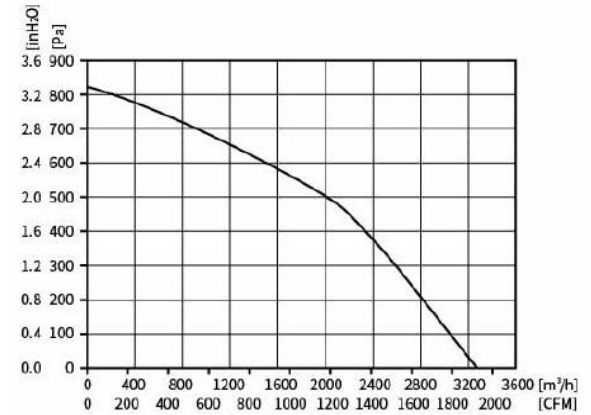

EC Backward Centrifugal Fan

Ø355x233mm

- Impeller: Metal Sheet
- Protection: IP44
- Insulation: Class B
- Certification: CE, RoHS
- Additional functions are optional



Model	Voltage	Frequency	Current	Power	Speed	Max Air Flow	Max Pressure	Noise
	VAC	Hz	Amp	Watt	RPM	M3/H	Pa	dB(A)
CTE355233V2L-M	230	50/60	2.02	467	1930	3720	740	73

EC Backward Centrifugal Fan

Ø355x233mm

- Dimension:

Unit: mm

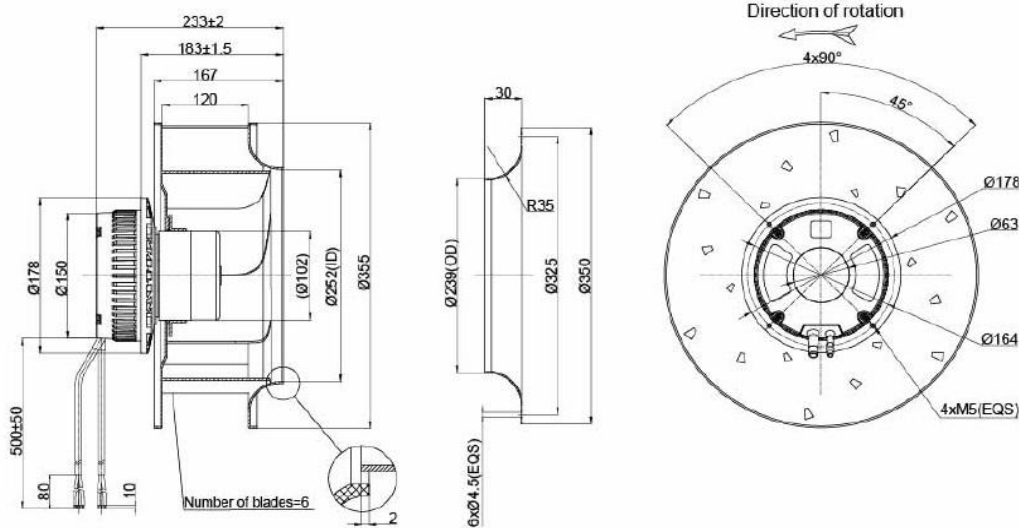

- Performance:

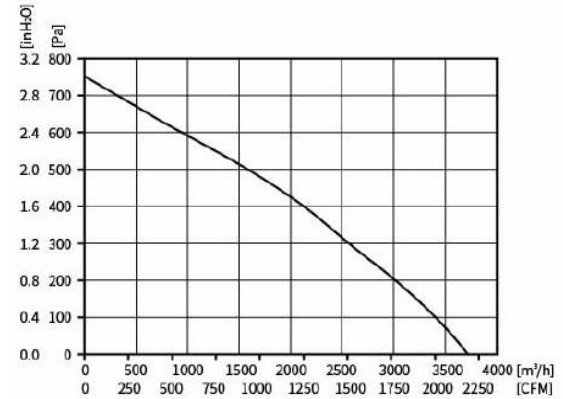

EC Backward Centrifugal Fan

Ø355x277mm

- Impeller: Metal Sheet
- Protection: IP44
- Insulation: Class B
- Certification: CE, RoHS
- Additional functions are optional



Model	Voltage	Frequency	Current	Power	Speed	Max Air Flow	Max Pressure	Noise
	VAC	Hz	Amp	Watt	RPM	M3/H	Pa	dB(A)
CTE355277V3M-M	380	50/60	2.8	1500	2500	5400	1300	89

EC Backward Centrifugal Fan

Ø355x277mm

- Dimension:

Unit: mm

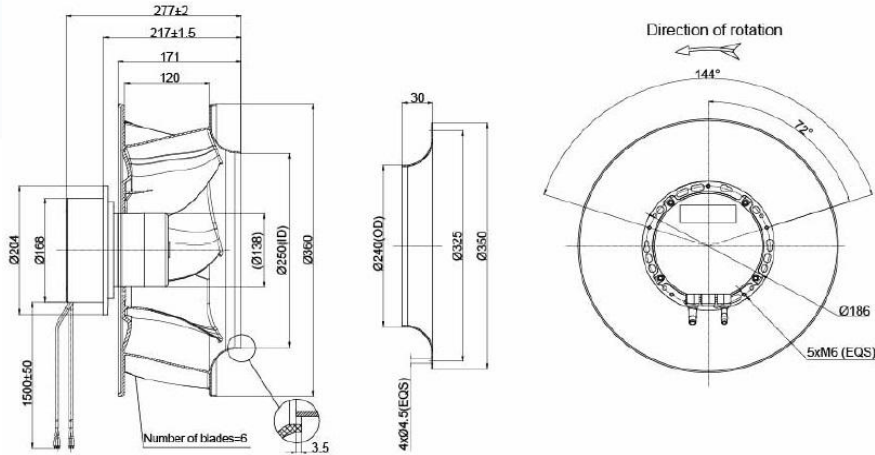

- Performance:

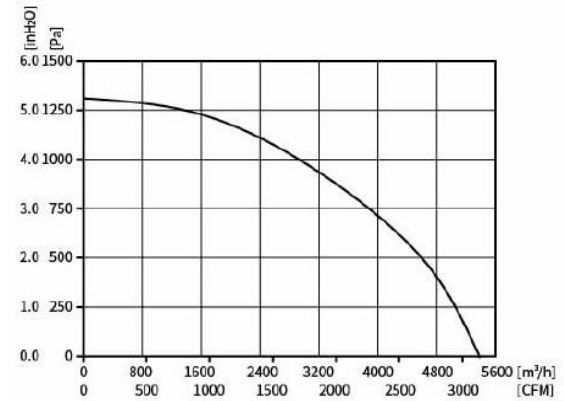

EC Backward Centrifugal Fan

Ø400x207mm

- Impeller: Metal Sheet
- Protection: IP44
- Insulation: Class B
- Certification: CE, RoHS
- Additional functions are optional



Model	Voltage	Frequency	Current	Power	Speed	Max Air Flow	Max Pressure	Noise
	VAC	Hz	Amp	Watt	RPM	M3/H	Pa	dB(A)
CTE400207V2L-M	230	50/60	1.3	280	1500	3410	545	72

EC Backward Centrifugal Fan

Ø400x207mm

- Dimension:

Unit: mm

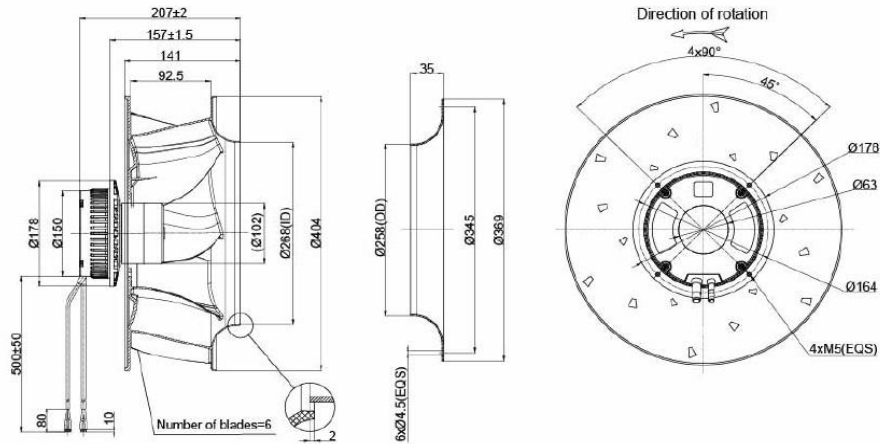

- Performance:

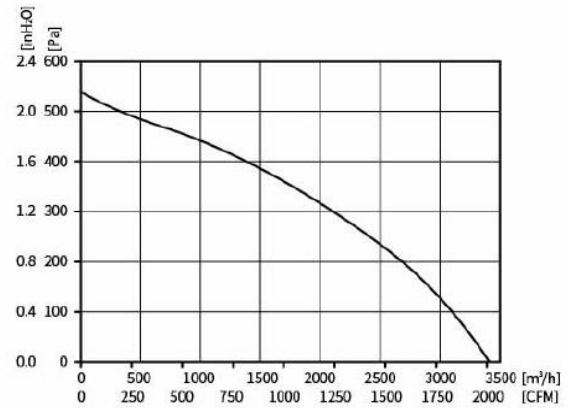

EC Backward Centrifugal Fan

Ø400x230mm

- Impeller: Metal Sheet
- Protection: IP44
- Insulation: Class B
- Certification: CE, RoHS
- Additional functions are optional



Model	Voltage	Frequency	Current	Power	Speed	Max Air Flow	Max Pressure	Noise
	VAC	Hz	Amp	Watt	RPM	M3/H	Pa	dB(A)
CTE400230V2L-M	230	50/60	1.3	300	1360	3800	560	72

EC Backward Centrifugal Fan

Ø400x230mm

- Dimension:
Unit: mm

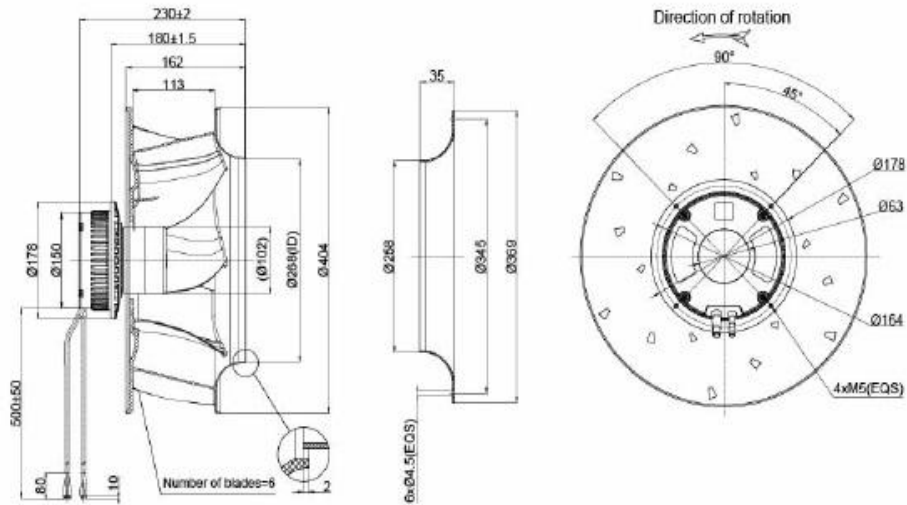

- Performance:

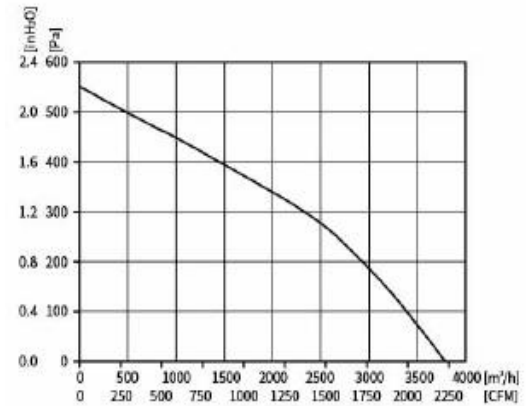

EC Backward Centrifugal Fan

Ø400x277mm

- Impeller: Metal Sheet
- Protection: IP44
- Insulation: Class B
- Certification: CE, RoHS
- Additional functions are optional



Model	Voltage	Frequency	Current	Power	Speed	Max Air Flow	Max Pressure	Noise
	VAC	Hz	Amp	Watt	RPM	M3/H	Pa	dB(A)
CTE400277V3L-M	380	50/60	1.2	720	1580	5400	530	73

EC Backward Centrifugal Fan

Ø400x277mm

- Dimension:
Unit: mm

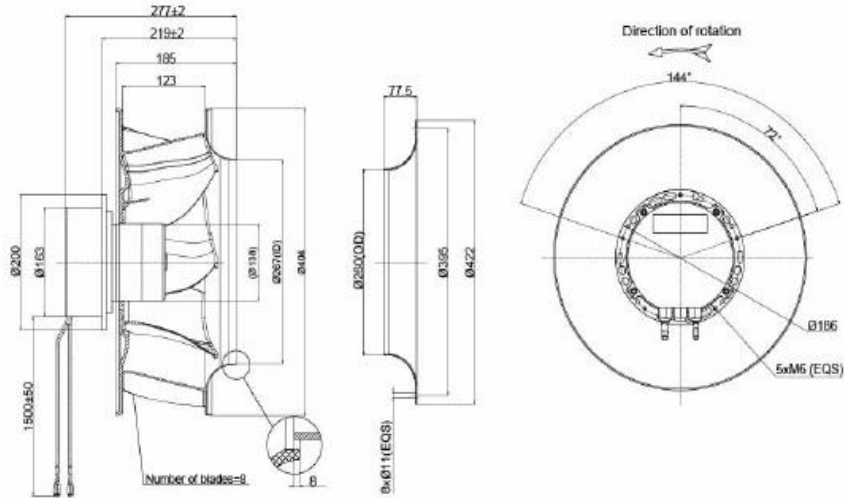

- Performance:

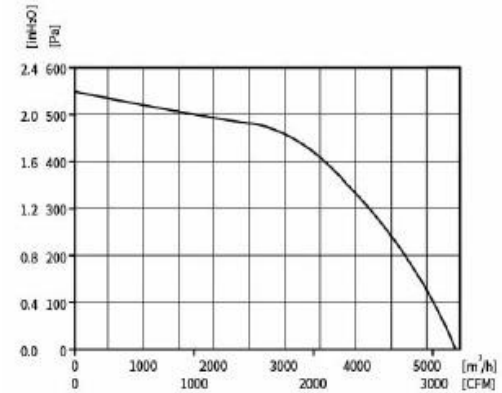

EC Backward Centrifugal Fan

Ø450x301mm

- Impeller: Metal Sheet
- Protection: IP44
- Insulation: Class B
- Certification: CE, RoHS
- Additional functions are optional



Model	Voltage	Frequency	Current	Power	Speed	Max Air Flow	Max Pressure	Noise
	VAC	Hz	Amp	Watt	RPM	M3/H	Pa	dB(A)
CTE450301V2L-M	230	50/60	4.3	1030	1700	8050	800	76

EC Backward Centrifugal Fan

Ø450x301mm

- Dimension:

Unit: mm

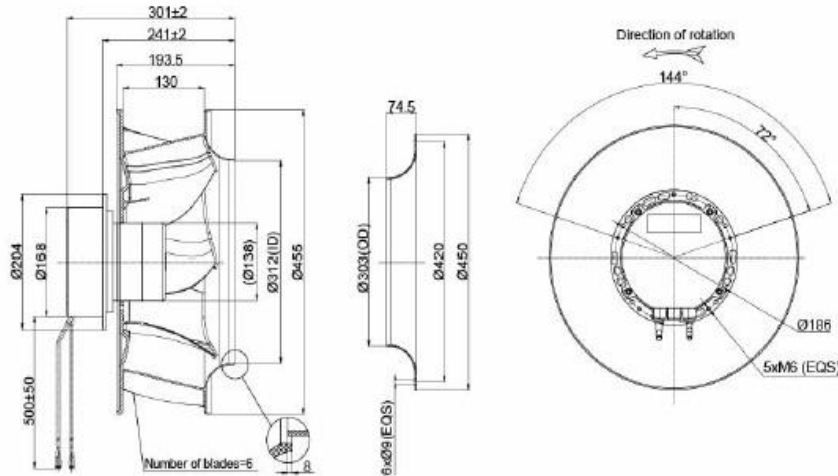

- Performance:

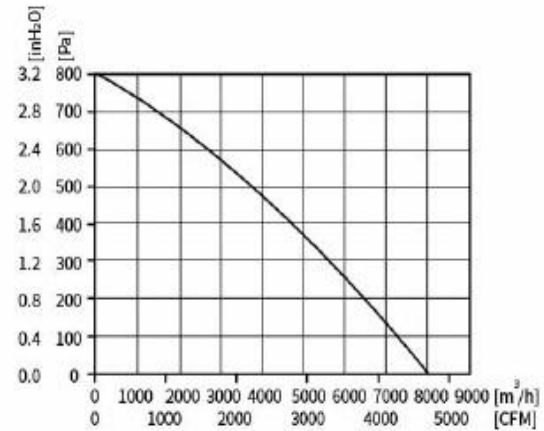

EC Backward Centrifugal Fan

Ø450x309mm

- Impeller: Metal Sheet
- Protection: IP44
- Insulation: Class B
- Certification: CE, RoHS
- Additional functions are optional



Model	Voltage	Frequency	Current	Power	Speed	Max Air Flow	Max Pressure	Noise
	VAC	Hz	Amp	Watt	RPM	M3/H	Pa	dB(A)
CTE450309V2L-M	230	50/60	3.3	700	1450	7100	580	84

EC Backward Centrifugal Fan

Ø450x309mm

- Dimension:
Unit: mm

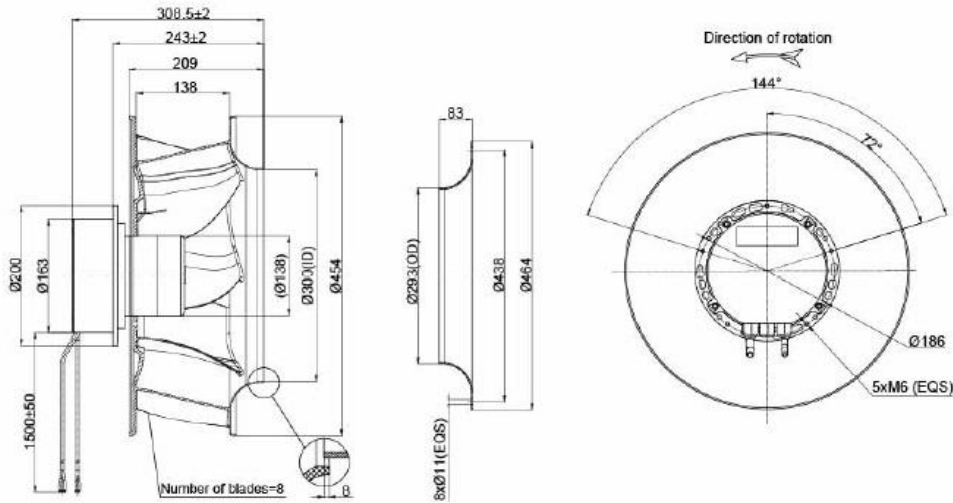

- Performance:

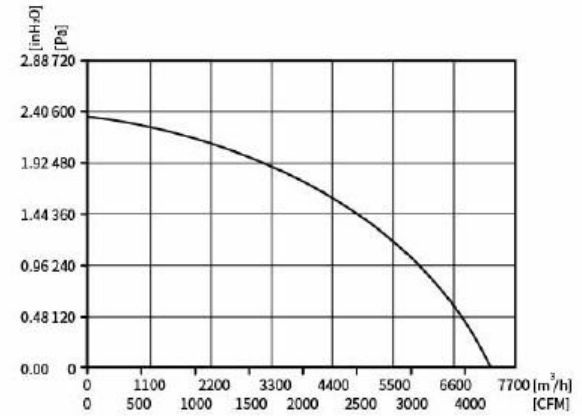

EC Backward Centrifugal Fan

Ø500x328mm

- Impeller: Metal Sheet
- Protection: IP44
- Insulation: Class B
- Certification: CE, RoHS
- Additional functions are optional



Model	Voltage	Frequency	Current	Power	Speed	Max Air Flow	Max Pressure	Noise
	VAC	Hz	Amp	Watt	RPM	M3/H	Pa	dB(A)
CTE500328V2LR-M	230	50/60	3.2	1125	710	7400	400	66

EC Backward Centrifugal Fan

Ø500x328mm

- Dimension:
Unit: mm

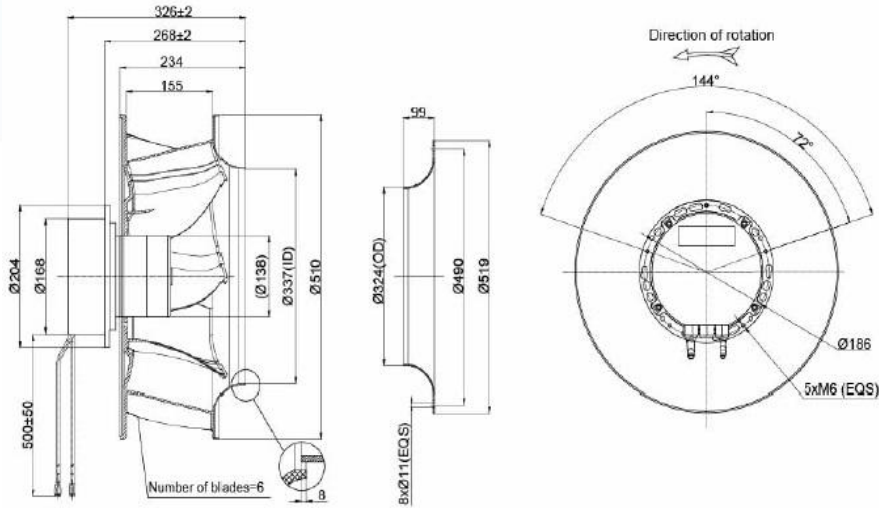

- Performance:

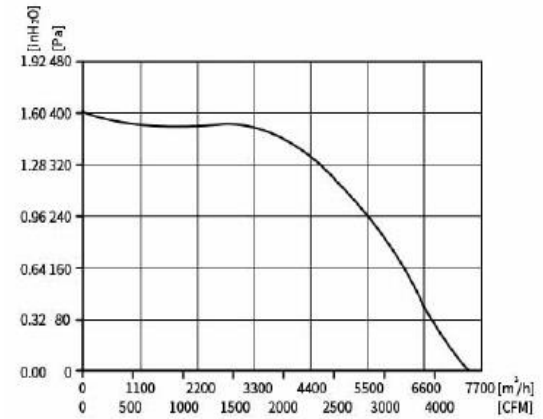

EC Backward Centrifugal Fan

Ø500x326mm

- Impeller: Metal Sheet
- Protection: IP44
- Insulation: Class B
- Certification: CE, RoHS
- Additional functions are optional



Model	Voltage	Frequency	Current	Power	Speed	Max Air Flow	Max Pressure	Noise
	VAC	Hz	Amp	Watt	RPM	M3/H	Pa	dB(A)
CTE500326V2L-M	380	50/60	1.46	870	1100	8000	450	71

EC Backward Centrifugal Fan

Ø500x326mm

- Dimension:

Unit: mm

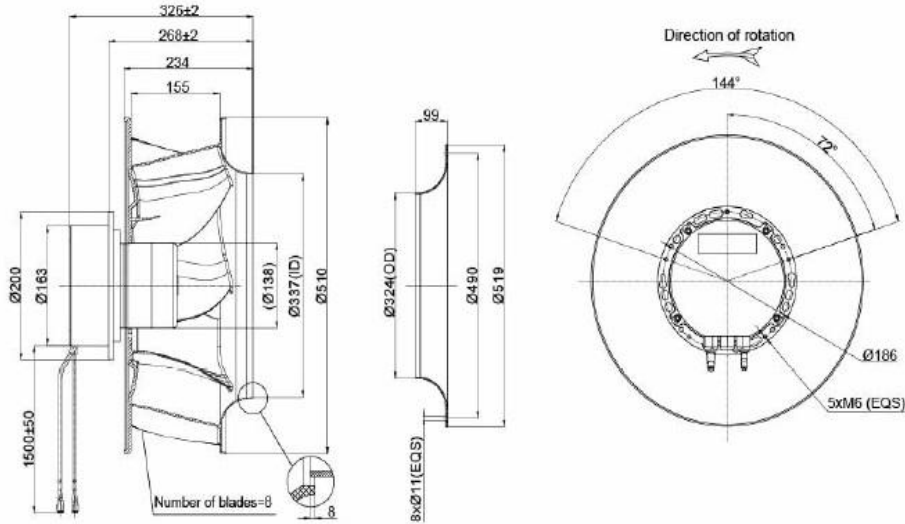

- Performance:

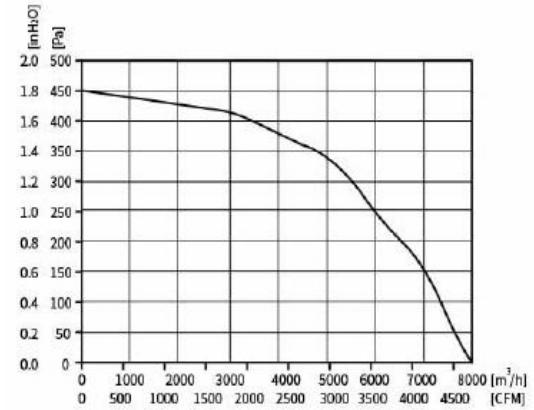

EC Backward Centrifugal Fan

Ø560x354mm

- Impeller: Metal Sheet
- Protection: IP44
- Insulation: Class B
- Certification: CE, RoHS
- Additional functions are optional



Model	Voltage	Frequency	Current	Power	Speed	Max Air Flow	Max Pressure	Noise
	VAC	Hz	Amp	Watt	RPM	M3/H	Pa	dB(A)
CTE560354V3LR-M	380	50/60	1.3	770	850	9100	320	69

EC Backward Centrifugal Fan

Ø560x354mm

- Dimension:
Unit: mm

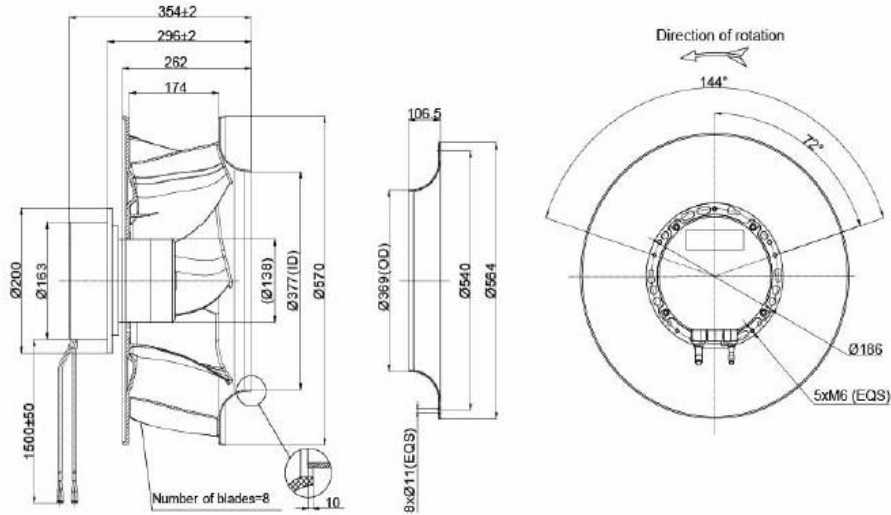

- Performance:

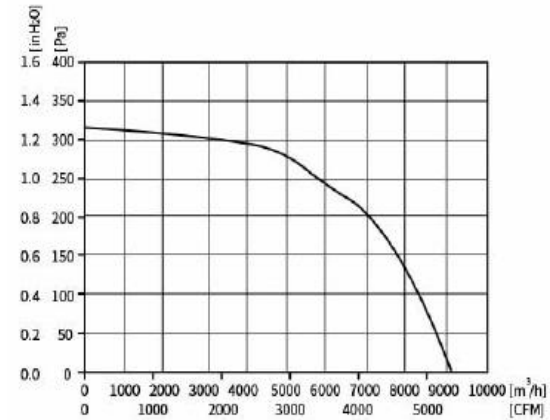

EC Backward Centrifugal Fan

Ø630x376mm

- Impeller: Metal Sheet
- Protection: IP44
- Insulation: Class B
- Certification: CE, RoHS
- Additional functions are optional



Model	Voltage	Frequency	Current	Power	Speed	Max Air Flow	Max Pressure	Noise
	VAC	Hz	Amp	Watt	RPM	M3/H	Pa	dB(A)
CTE630376V3L-M	380	50/60	4.4	2700	1250	18500	890	85

EC Backward Centrifugal Fan

Ø630x376mm

- Dimension:

Unit: mm

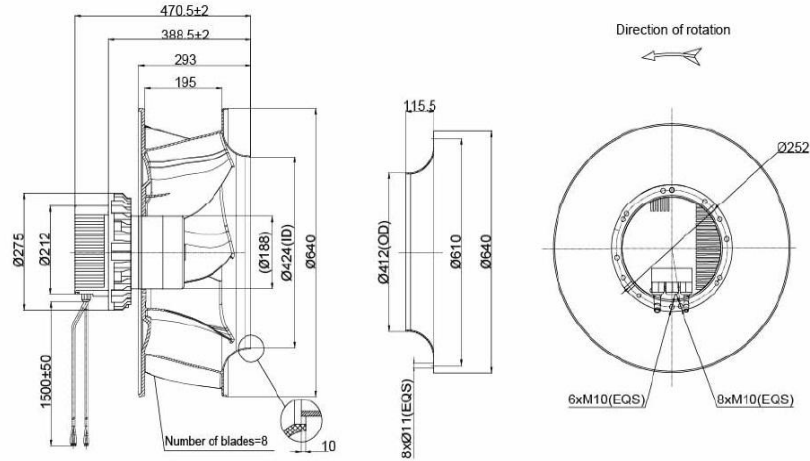

- Performance:

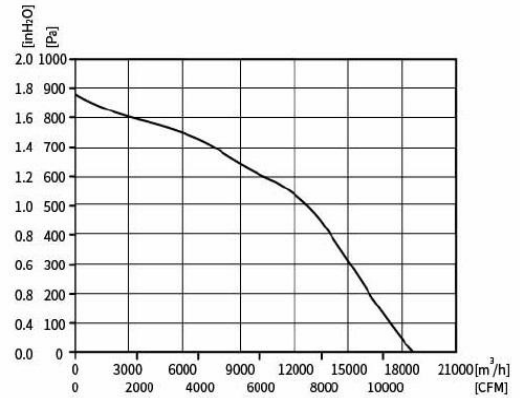

EC Forward Centrifugal Fan

Ø108x94mm

- Impeller: Steel Plate
- Protection: IP44
- Insulation: Class B
- Certification: CE, RoHS
- Additional functions are optional



Model	Voltage	Frequency	Current	Power	Speed	Max Air Flow	Max Pressure	Noise
	VAC	Hz	Amp	Watt	RPM	M3/H	Pa	dB(A)
CTFE10894V2M-M	230	50/60	0.43	48	2550	256	261	64

EC Forward Centrifugal Fan

Ø108x94mm

- Dimension:

Unit: mm

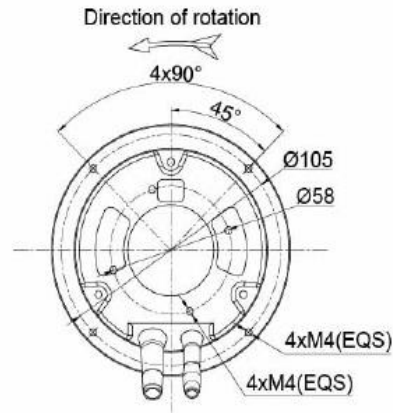
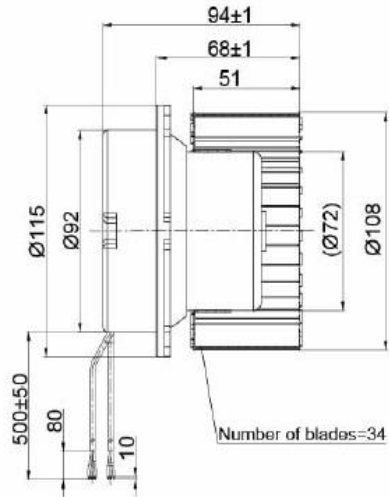

- Performance:

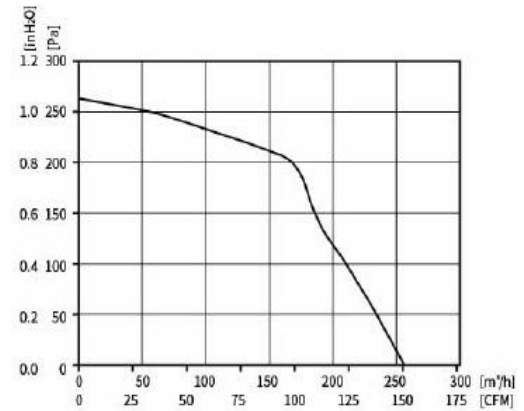

EC Forward Centrifugal Fan

Ø120x98mm

- Impeller: Steel Plate
- Protection: IP44
- Insulation: Class B
- Certification: CE, RoHS
- Additional functions are optional



Model	Voltage	Frequency	Current	Power	Speed	Max Air Flow	Max Pressure	Noise
	VAC	Hz	Amp	Watt	RPM	M3/H	Pa	dB(A)
CTFE12098V2M-M	230	50/60	0.53	61	2488	270	330	65

EC Forward Centrifugal Fan

Ø120x98mm

- Dimension:

Unit: mm

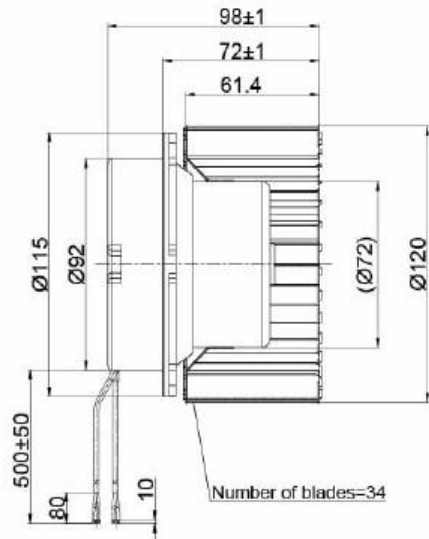

- Performance:

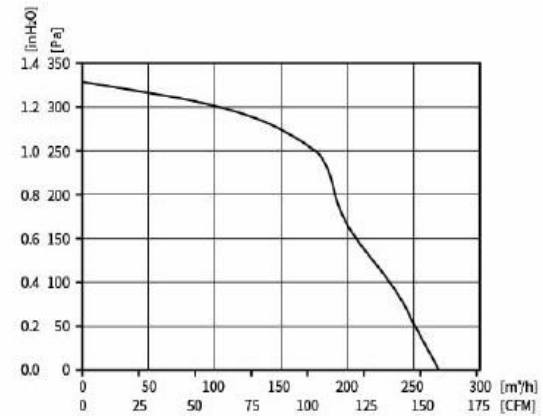

EC Forward Centrifugal Fan

Ø133x81mm

- Impeller: Steel Plate
- Protection: IP44
- Insulation: Class B
- Certification: CE, RoHS
- Additional functions are optional



Model	Voltage	Frequency	Current	Power	Speed	Max Air Flow	Max Pressure	Noise
	VAC	Hz	Amp	Watt	RPM	M3/H	Pa	dB(A)
CTFE13381V2L-M	230	50/60	0.3	38	1920	220	275	63

EC Forward Centrifugal Fan

Ø133x81mm

- Dimension:
Unit: mm

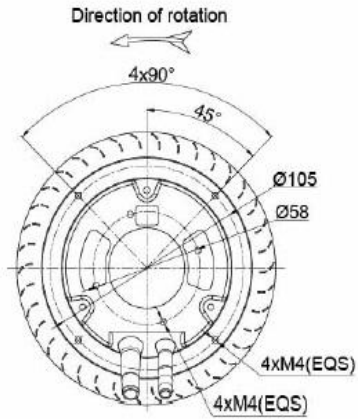
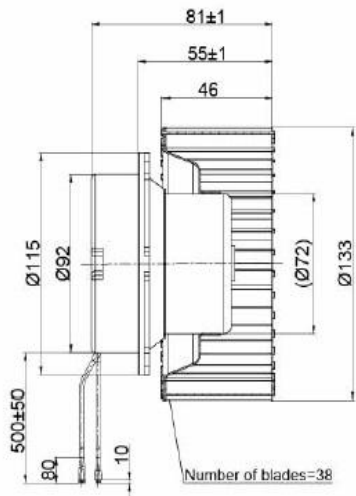

- Performance:

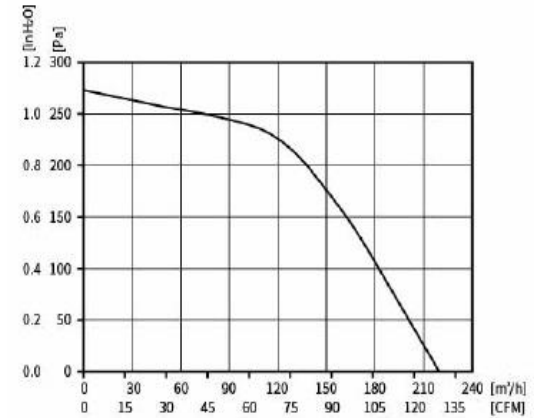

EC Forward Centrifugal Fan

Ø140x98mm

- Impeller: Steel Plate
- Protection: IP44
- Insulation: Class B
- Certification: CE, RoHS
- Additional functions are optional



Model	Voltage	Frequency	Current	Power	Speed	Max Air Flow	Max Pressure	Noise
	VAC	Hz	Amp	Watt	RPM	M3/H	Pa	dB(A)
CTFE14098V2L-M	230	50/60	0.55	64	1685	450	208	63

EC Forward Centrifugal Fan

Ø140x98mm

- Dimension:

Unit: mm

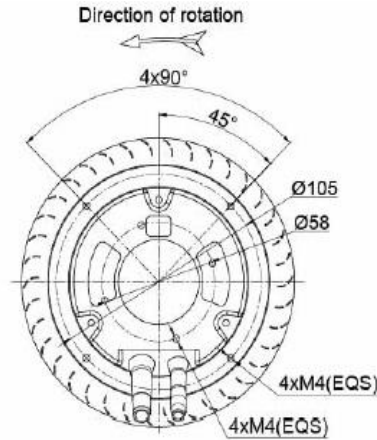
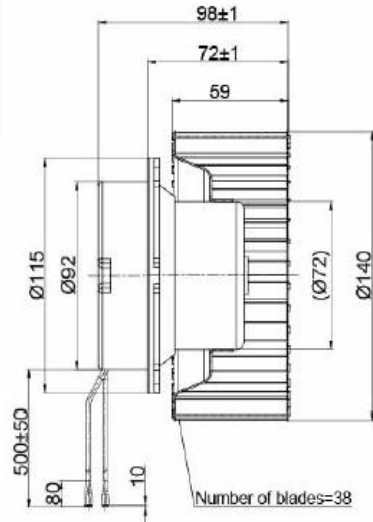

- Performance:

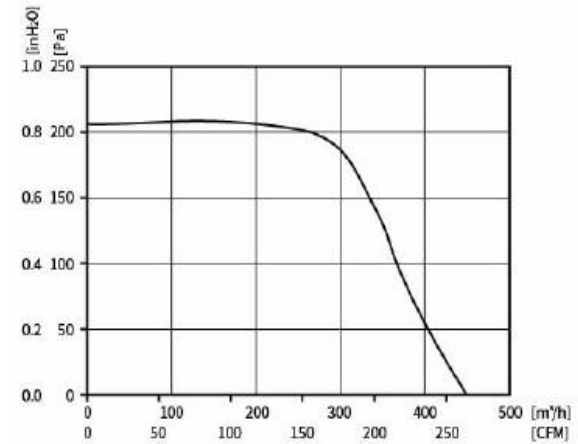

EC Forward Centrifugal Fan

Ø146x103mm

- Impeller: Steel Plate
- Protection: IP44
- Insulation: Class B
- Certification: CE, RoHS
- Additional functions are optional



Model	Voltage	Frequency	Current	Power	Speed	Max Air Flow	Max Pressure	Noise
	VAC	Hz	Amp	Watt	RPM	M3/H	Pa	dB(A)
CTFE146103V2M-M	230	50/60	1.3	175	2520	610	666	71

EC Forward Centrifugal Fan

Ø146x103mm

- Dimension:
Unit: mm

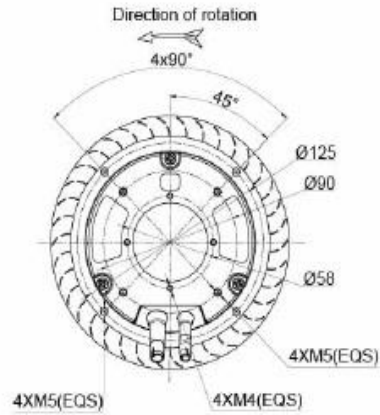
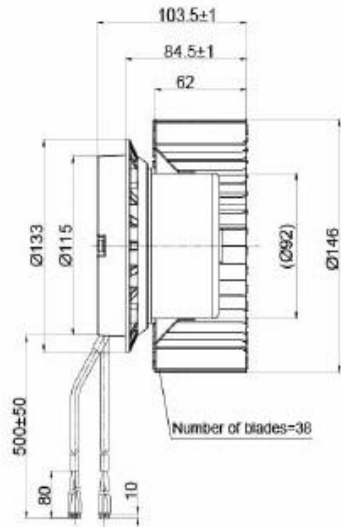

- Performance:

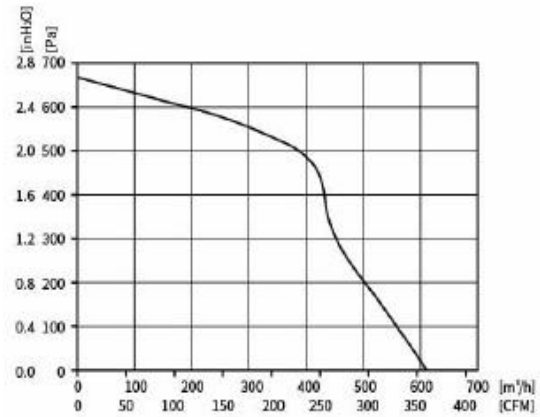

EC Forward Centrifugal Fan

Ø160x100mm

- Impeller: Steel Plate
- Protection: IP44
- Insulation: Class B
- Certification: CE, RoHS
- Additional functions are optional



Model	Voltage	Frequency	Current	Power	Speed	Max Air Flow	Max Pressure	Noise
	VAC	Hz	Amp	Watt	RPM	M3/H	Pa	dB(A)
CTFE160100V2M-M	230	50/60	1.28	177	2160	670	378	70

EC Forward Centrifugal Fan

Ø160x100mm

- Dimension:

Unit: mm

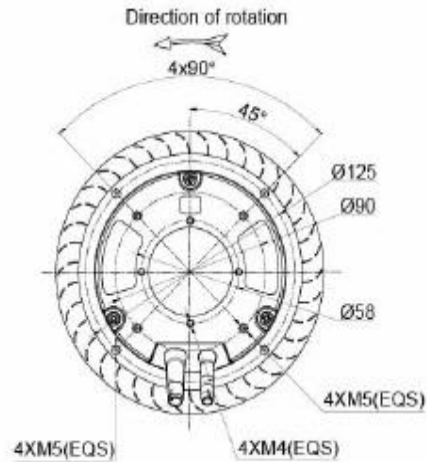
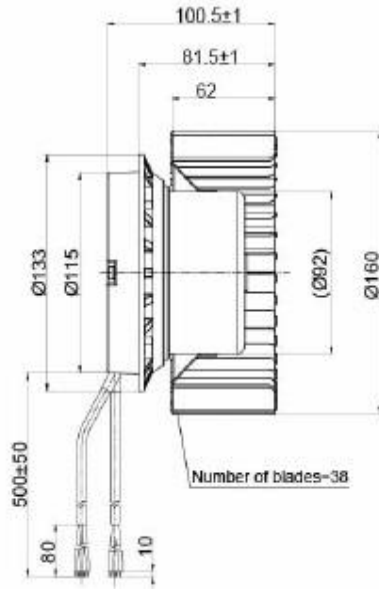

- Performance:

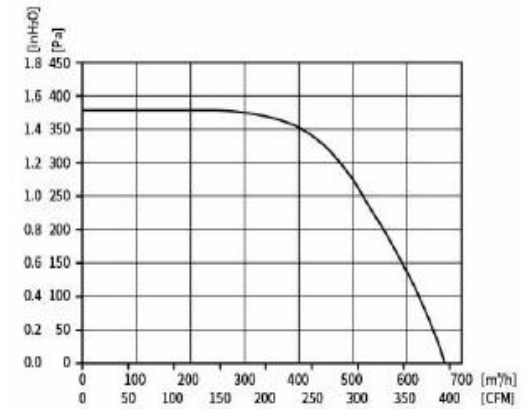

EC Forward Centrifugal Fan

Ø180x129mm

- Impeller: Steel Plate
- Protection: IP44
- Insulation: Class B
- Certification: CE, RoHS
- Additional functions are optional



Model	Voltage	Frequency	Current	Power	Speed	Max Air Flow	Max Pressure	Noise
	VAC	Hz	Amp	Watt	RPM	M3/H	Pa	dB(A)
CTFE180129V2M-M	230	50/60	1.2	168	2250	1100	237	60

EC Forward Centrifugal Fan

Ø180x129mm

- Dimension:

Unit: mm

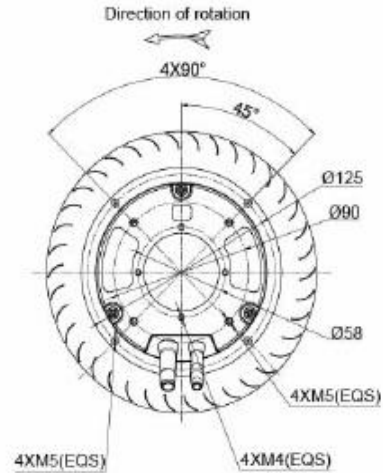
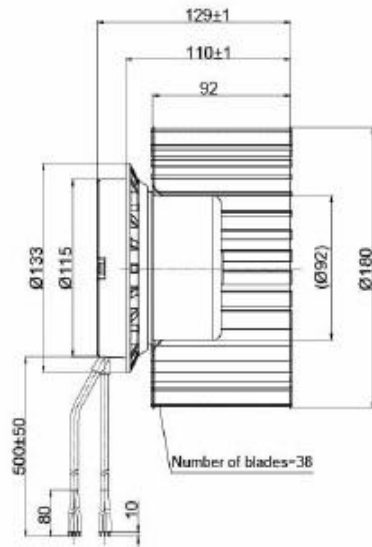

- Performance:

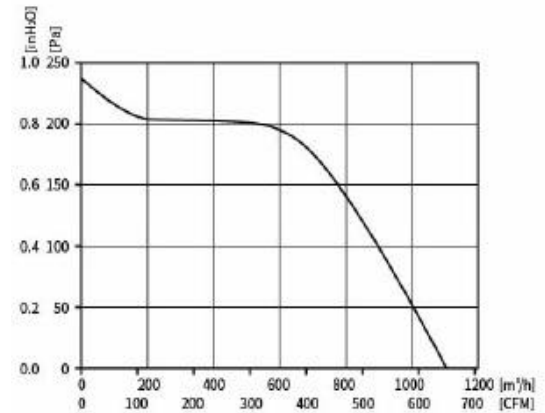

EC Forward Centrifugal Fan

Ø200x176mm

- Impeller: Steel Plate
- Protection: IP44
- Insulation: Class B
- Certification: CE, RoHS
- Additional functions are optional



Model	Voltage	Frequency	Current	Power	Speed	Max Air Flow	Max Pressure	Noise
	VAC	Hz	Amp	Watt	RPM	M3/H	Pa	dB(A)
CTFE200176V2L-M	230	50/60	3.1	510	1800	1700	440	77

EC Forward Centrifugal Fan

Ø200x176mm

- Dimension:
Unit: mm

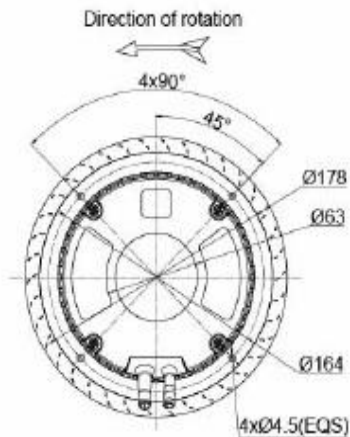
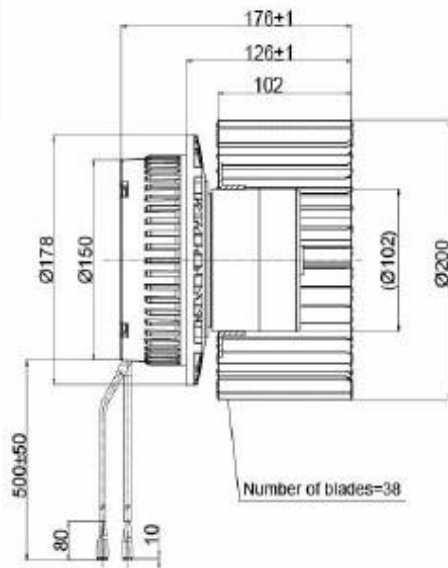

- Performance:

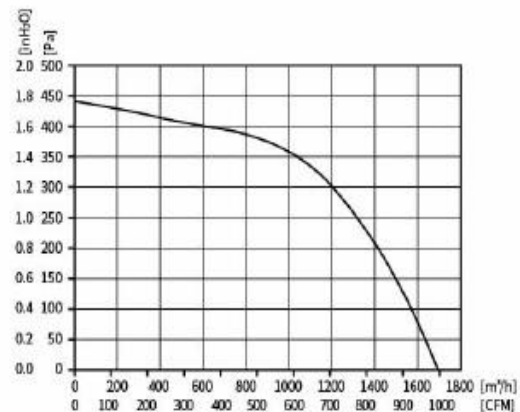

EC Single Inlet Blower

Ø120x172mm

- Impeller: Steel Plate
- Protection: IP44
- Insulation: Class B
- Certification: CE, RoHS
- Additional functions are optional



Model	Voltage	Frequency	Current	Power	Speed	Max Air Flow	Max Pressure	Noise
	VAC	Hz	Amp	Watt	RPM	M3/H	Pa	dB(A)
CTBE120172V2M-M	230	50/60	0.4	55	2400	317	471	58

EC Single Inlet Blower

Ø120x172mm

- Dimension:
Unit: mm

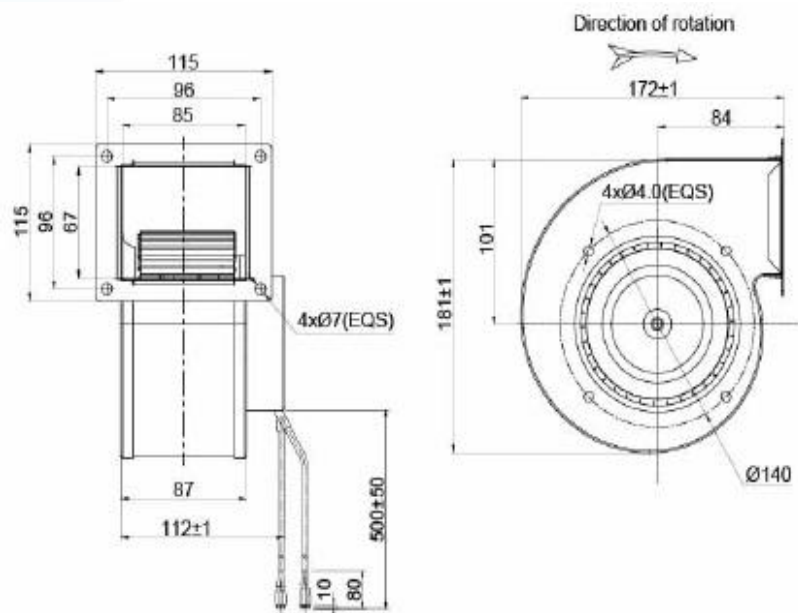

- Performance:

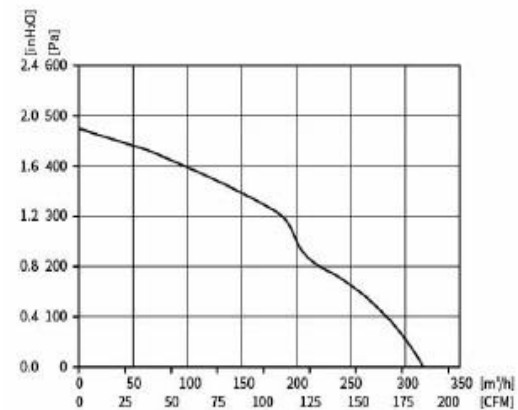

EC Single Inlet Blower

Ø140x220mm

- Impeller: Steel Plate
- Protection: IP44
- Insulation: Class B
- Certification: CE, RoHS
- Additional functions are optional



Model	Voltage	Frequency	Current	Power	Speed	Max Air Flow	Max Pressure	Noise
	VAC	Hz	Amp	Watt	RPM	M3/H	Pa	dB(A)
CTBE140220V2M-M	230	50/60	1.2	170	2600	567.7	696	70

EC Single Inlet Blower

Ø140x220mm

- Dimension:

Unit: mm

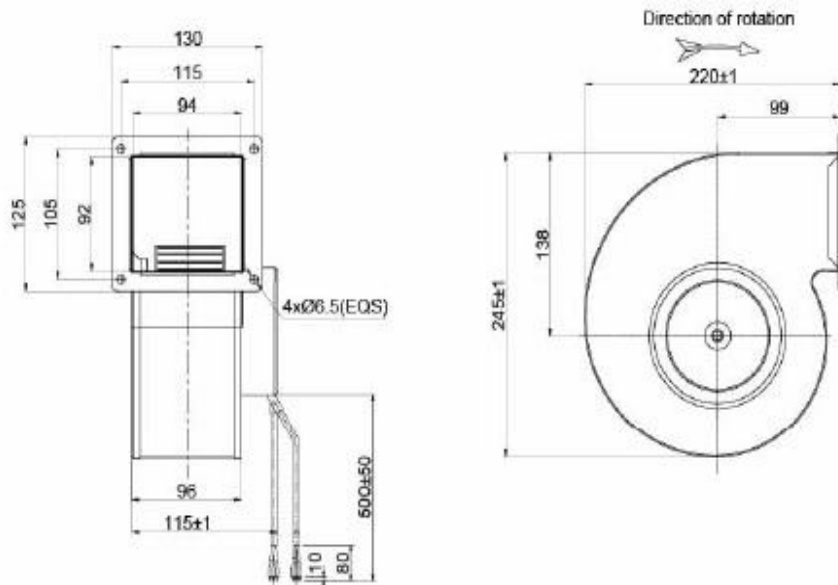

- Performance:

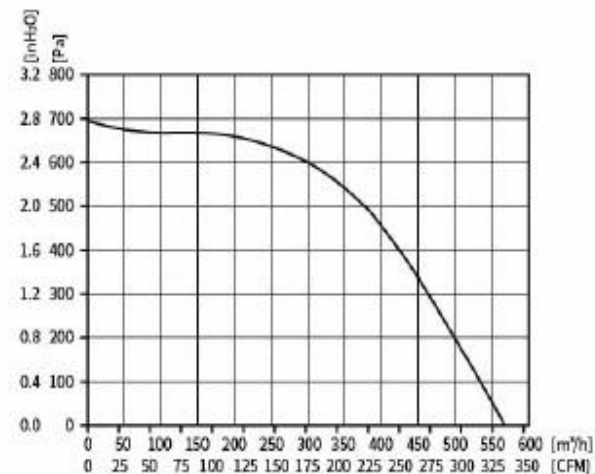

EC Single Inlet Blower

Ø160x220mm

- Impeller: Steel Plate
- Protection: IP44
- Insulation: Class B
- Certification: CE, RoHS
- Additional functions are optional



Model	Voltage	Frequency	Current	Power	Speed	Max Air Flow	Max Pressure	Noise
	VAC	Hz	Amp	Watt	RPM	M3/H	Pa	dB(A)
CTBE160220V2L-M	230	50/60	1.2	170	1950	688	810	72

EC Single Inlet Blower

Ø160x220mm

- Dimension:
Unit: mm

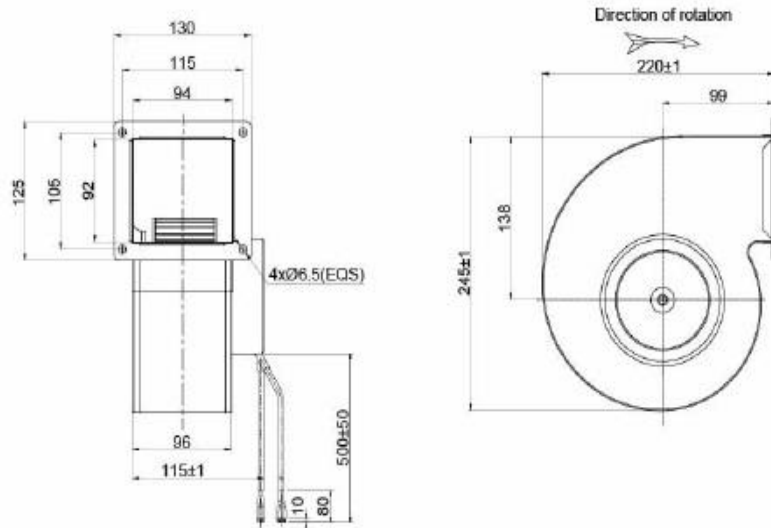

- Performance:

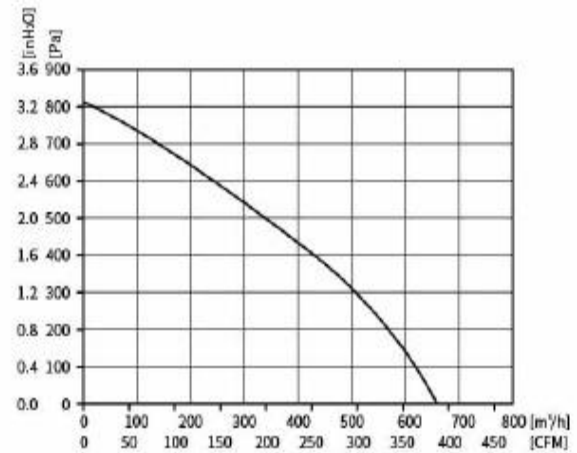

EC Single Inlet Blower

Ø180x262mm

- Impeller: Steel Plate
- Protection: IP44
- Insulation: Class B
- Certification: CE, RoHS
- Additional functions are optional



Model	Voltage	Frequency	Current	Power	Speed	Max Air Flow	Max Pressure	Noise
	VAC	Hz	Amp	Watt	RPM	M3/H	Pa	dB(A)
CTBE180262V2L-M	230	50/60	1.2	170	1500	820	900	70

EC Single Inlet Blower

Ø180x262mm

- Dimension:
Unit: mm

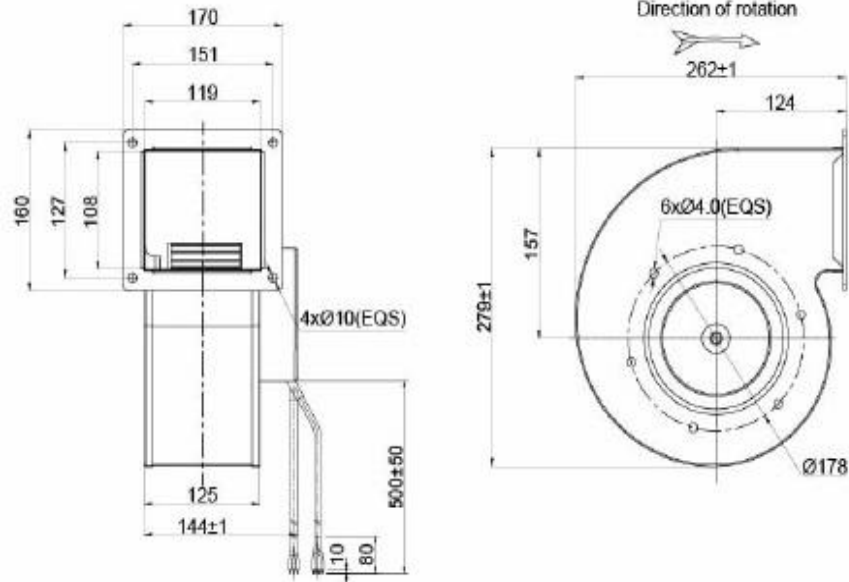

- Performance:

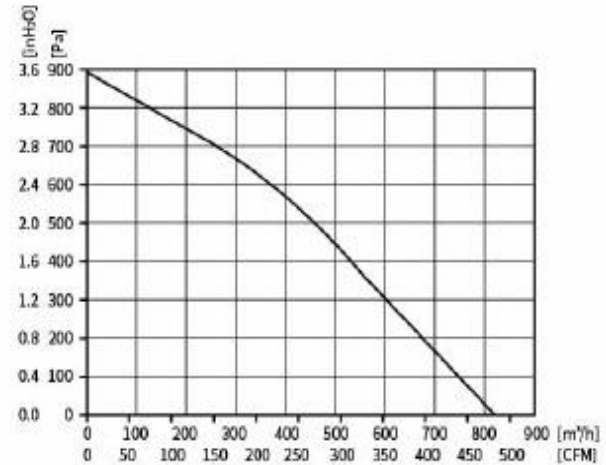

EC Single Inlet Blower

Ø200x303mm

- Impeller: Steel Plate
- Protection: IP44
- Insulation: Class B
- Certification: CE, RoHS
- Additional functions are optional



Model	Voltage	Frequency	Current	Power	Speed	Max Air Flow	Max Pressure	Noise
	VAC	Hz	Amp	Watt	RPM	M3/H	Pa	dB(A)
CTBE200303V2L-M	230	50/60	1.5	220	1600	792	708	64

EC Single Inlet Blower

Ø200x303mm

- Dimension:
Unit: mm

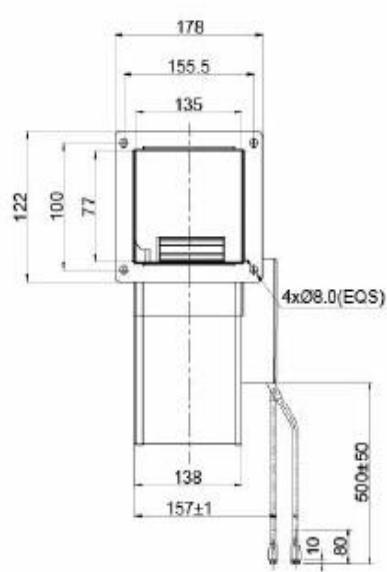

- Performance:

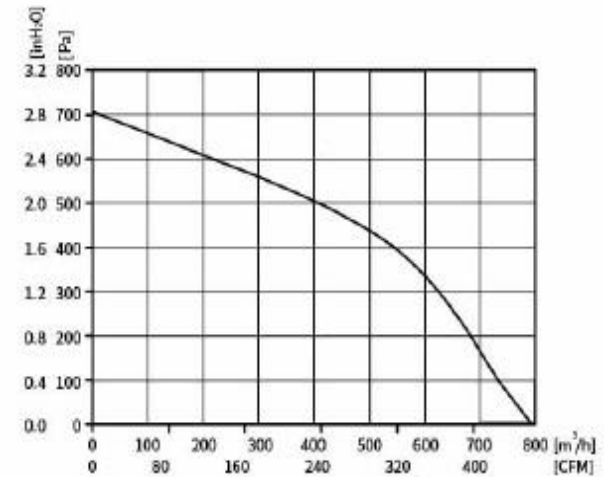

EC Single Inlet Blower

Ø225x405mm

- Impeller: Steel Plate
- Protection: IP44
- Insulation: Class B
- Certification: CE, RoHS
- Additional functions are optional



Model	Voltage	Frequency	Current	Power	Speed	Max Air Flow	Max Pressure	Noise
	VAC	Hz	Amp	Watt	RPM	M3/H	Pa	dB(A)
CTBE225405V2L-M	230	50/60	1.1	230	1090	1360	620	55

EC Single Inlet Blower

Ø225x405mm

- Dimension:

Unit: mm

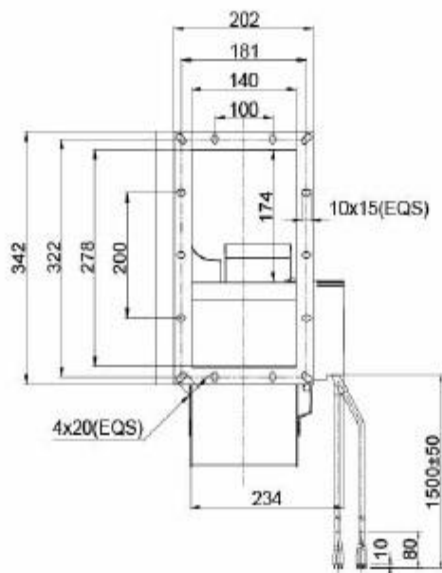

- Performance:

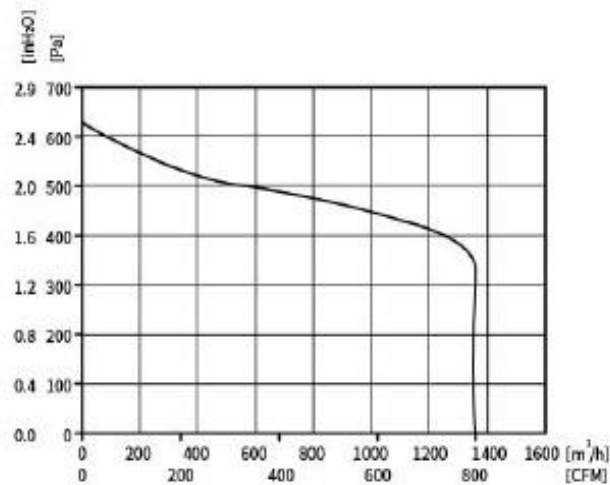

EC Single Inlet Blower

Ø250x440mm

- Impeller: Steel Plate
- Protection: IP44
- Insulation: Class B
- Certification: CE, RoHS
- Additional functions are optional



Model	Voltage	Frequency	Current	Power	Speed	Max Air Flow	Max Pressure	Noise
	VAC	Hz	Amp	Watt	RPM	M3/H	Pa	dB(A)
CTBE250440V2LR-M	230	50/60	1.1	230	840	1710	580	50

EC Single Inlet Blower

Ø250x440mm

- Dimension:

Unit: mm

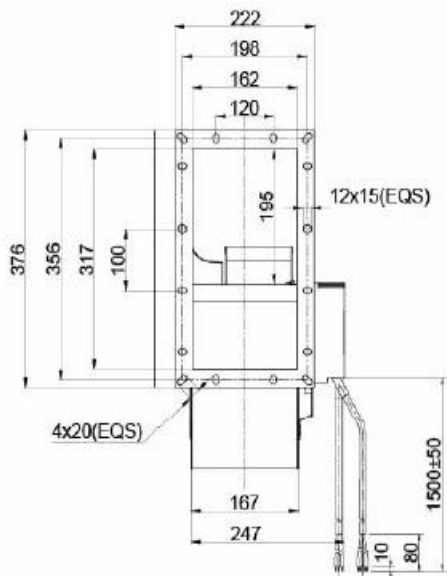

- Performance:

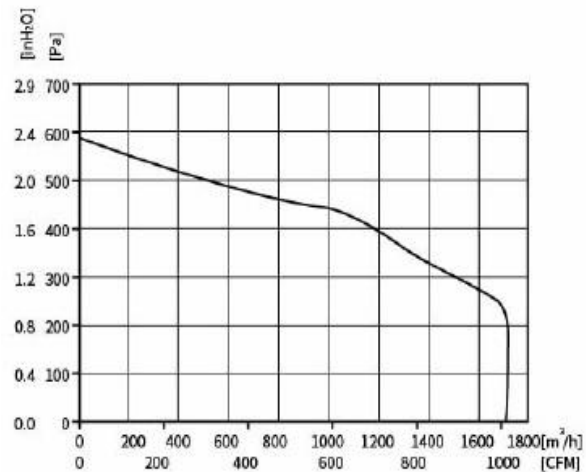

EC Single Inlet Blower

Ø280x485mm

- Impeller: Steel Plate
- Protection: IP44
- Insulation: Class B
- Certification: CE, RoHS
- Additional functions are optional



Model	Voltage	Frequency	Current	Power	Speed	Max Air Flow	Max Pressure	Noise
	VAC	Hz	Amp	Watt	RPM	M3/H	Pa	dB(A)
CTBE280485V3L-M	380	50/60	1.6	950	1150	3000	650	79

EC Single Inlet Blower

Ø280x485mm

- Dimension:

Unit: mm

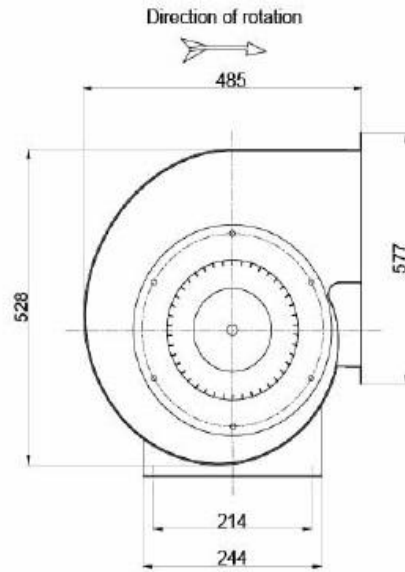
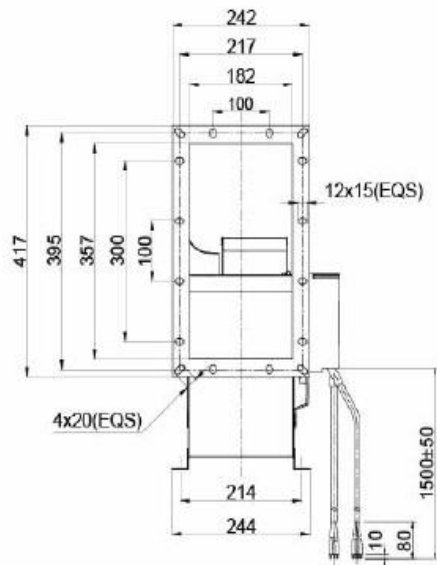

- Performance:

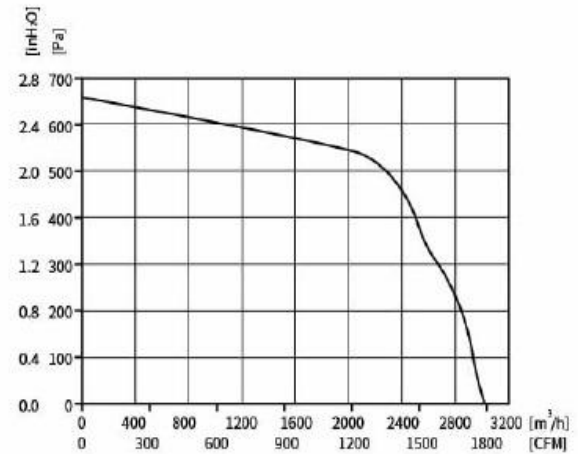

EC Double Inlet Blower

Ø133x176mm

- Impeller: Steel Plate
- Protection: IP44
- Insulation: Class B
- Certification: CE, RoHS
- Additional functions are optional



Model	Voltage	Frequency	Current	Power	Speed	Max Air Flow	Max Pressure	Noise
	VAC	Hz	Amp	Watt	RPM	M3/H	Pa	dB(A)
CTBE133176V2L-M	230	50/60	0.9	120	1500	880	340	65

EC Double Inlet Blower

Ø133x176mm

- Dimension:

Unit: mm

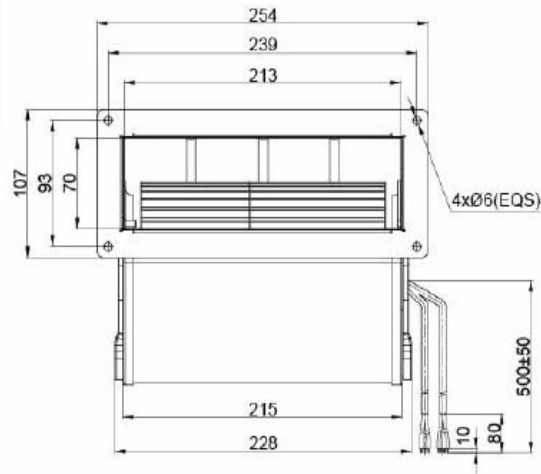

- Performance:

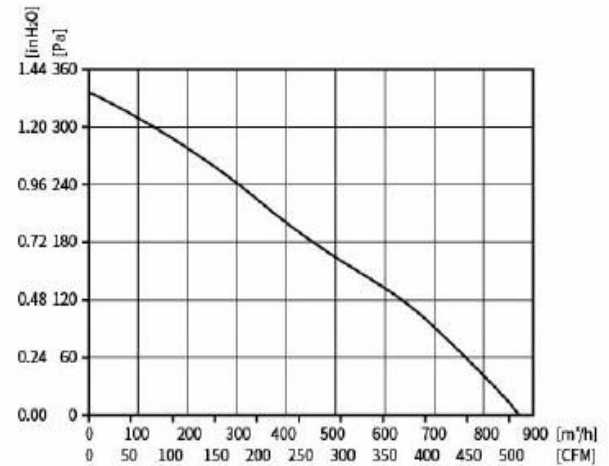

EC Double Inlet Blower

Ø146x209mm

- Impeller: Steel Plate
- Protection: IP44
- Insulation: Class B
- Certification: CE, RoHS
- Additional functions are optional



Model	Voltage	Frequency	Current	Power	Speed	Max Air Flow	Max Pressure	Noise
	VAC	Hz	Amp	Watt	RPM	M3/H	Pa	dB(A)
CTBE146209V2L-M	230	50/60	1.4	190	1750	1340	620	72

EC Double Inlet Blower

Ø146x209mm

- Dimension:

Unit: mm

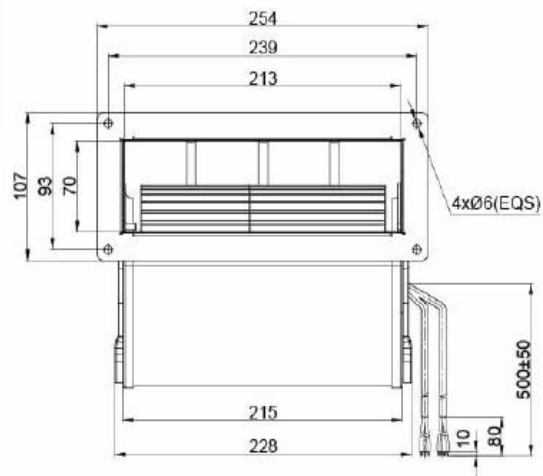

- Performance:

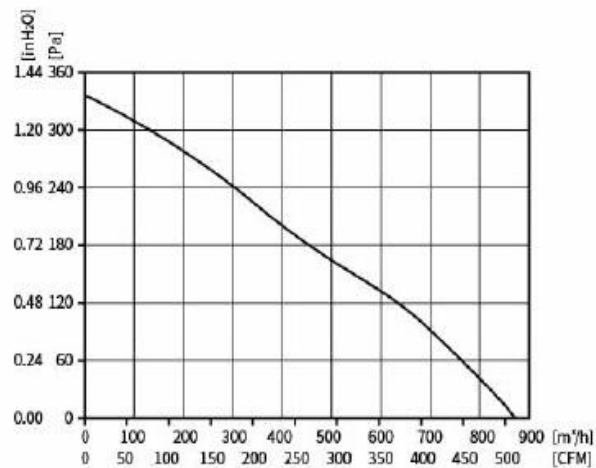

EC Double Inlet Blower

Ø180x262mm - B Type

- Impeller: Steel Plate
- Protection: IP44
- Insulation: Class B
- Certification: CE, RoHS
- Additional functions are optional



Model	Voltage	Frequency	Current	Power	Speed	Max Air Flow	Max Pressure	Noise
	VAC	Hz	Amp	Watt	RPM	M3/H	Pa	dB(A)
CTBE180262V2L-M2	230	50/60	1.9	400	1550	2000	710	74

EC Double Inlet Blower

Ø180x262mm - B

Type

- Dimension:

Unit: mm

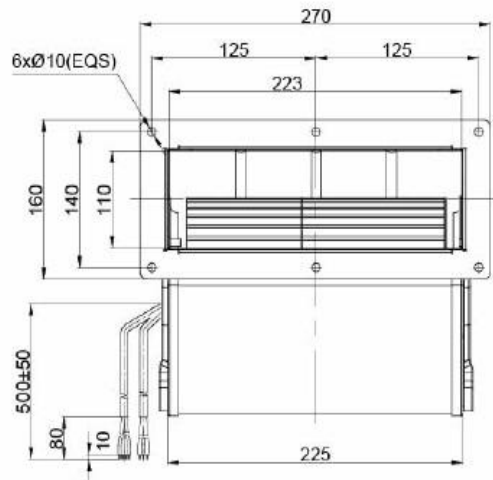

- Performance:

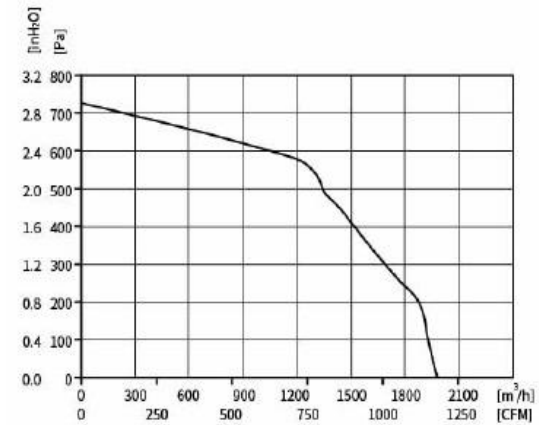

EC Double Inlet Blower

Ø200x309mm

- Impeller: Steel Plate
- Protection: IP44
- Insulation: Class B
- Certification: CE, RoHS
- Additional functions are optional



Model	Voltage	Frequency	Current	Power	Speed	Max Air Flow	Max Pressure	Noise
	VAC	Hz	Amp	Watt	RPM	M3/H	Pa	dB(A)
CTBE200309V2L-M	230	50/60	1.36	300	1150	2000	1000	64

EC Double Inlet Blower

Ø200x309mm

- Dimension:

Unit: mm

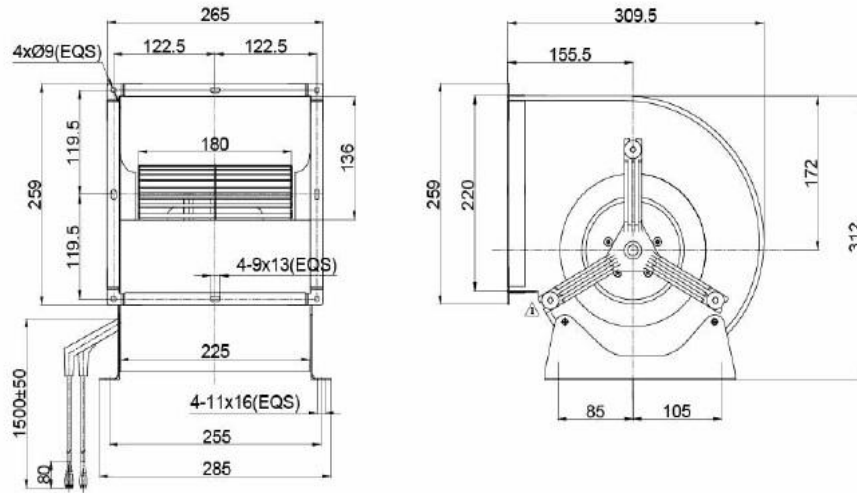

- Performance:

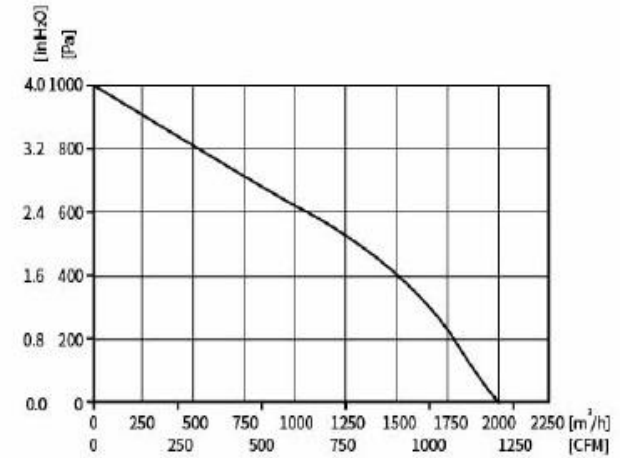

EC Double Inlet Blower

Ø225x342mm

- Impeller: Steel Plate
- Protection: IP44
- Insulation: Class B
- Certification: CE, RoHS
- Additional functions are optional



Model	Voltage	Frequency	Current	Power	Speed	Max Air Flow	Max Pressure	Noise
	VAC	Hz	Amp	Watt	RPM	M3/H	Pa	dB(A)
CTBE225342V3L-M	380	50/60	1.8	1050	1450	3500	560	78

EC Double Inlet Blower

Ø225x342mm

- Dimension:

Unit: mm

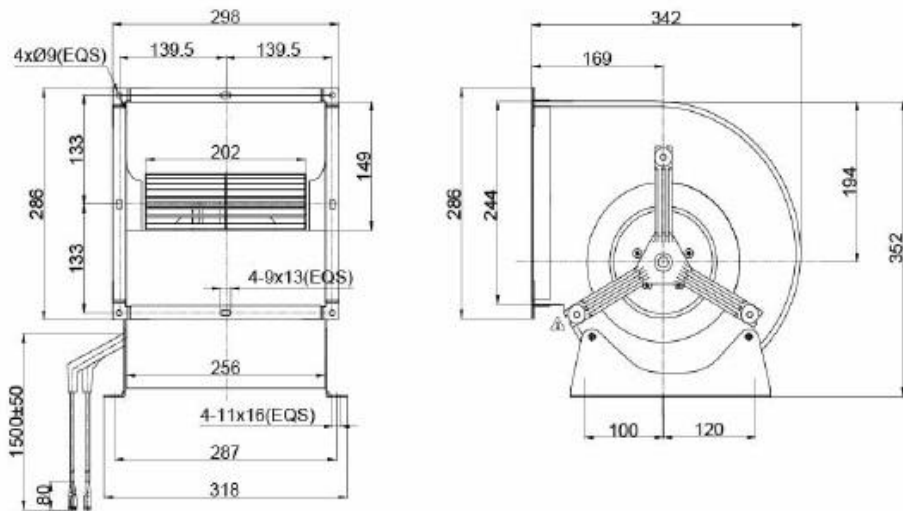

- Performance:

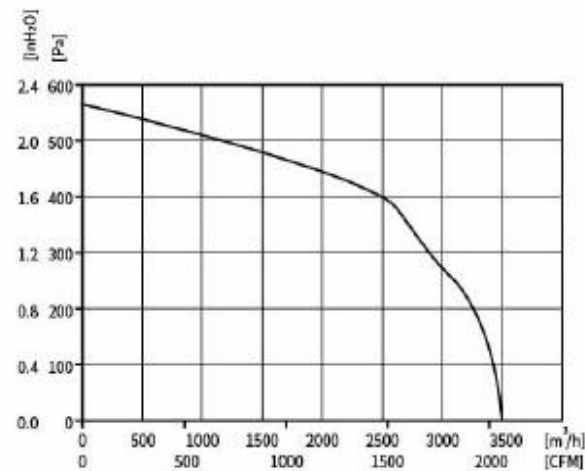

EC Double Inlet Blower

Ø250x376mm

- Impeller: Steel Plate
- Protection: IP44
- Insulation: Class B
- Certification: CE, RoHS
- Additional functions are optional



Model	Voltage	Frequency	Current	Power	Speed	Max Air Flow	Max Pressure	Noise
	VAC	Hz	Amp	Watt	RPM	M3/H	Pa	dB(A)
CTBE250376V3L-M	380	50/60	1.2	655	920	3640	720	74

EC Double Inlet Blower

Ø250x376mm

- Dimension:

Unit: mm

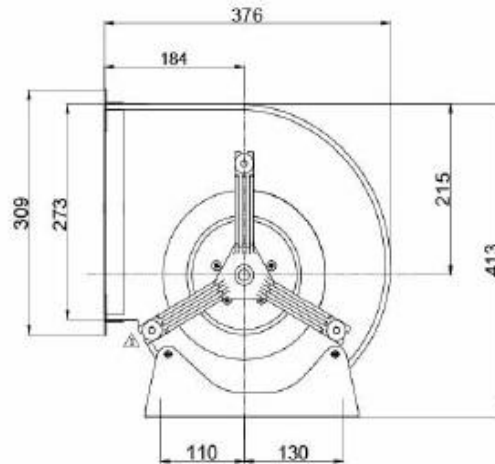
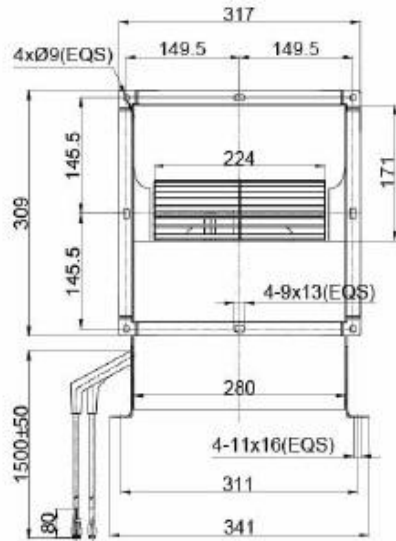

- Performance:

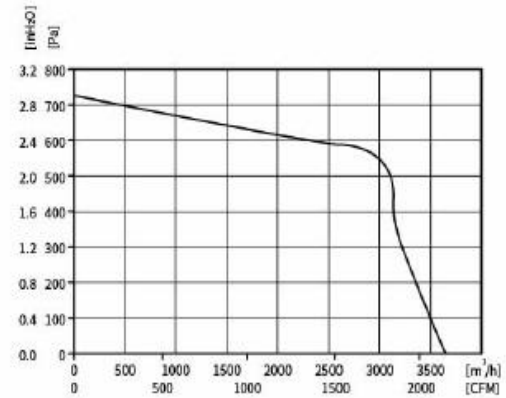

EC Double Inlet Blower

Ø280x416mm

- Impeller: Steel Plate
- Protection: IP44
- Insulation: Class B
- Certification: CE, RoHS
- Additional functions are optional



Model	Voltage	Frequency	Current	Power	Speed	Max Air Flow	Max Pressure	Noise
	VAC	Hz	Amp	Watt	RPM	M3/H	Pa	dB(A)
CTBE280416V3L-M	380	50/60	1.1	600	800	4100	890	72

EC Double Inlet Blower

Ø280x416mm

- Dimension:

Unit: mm

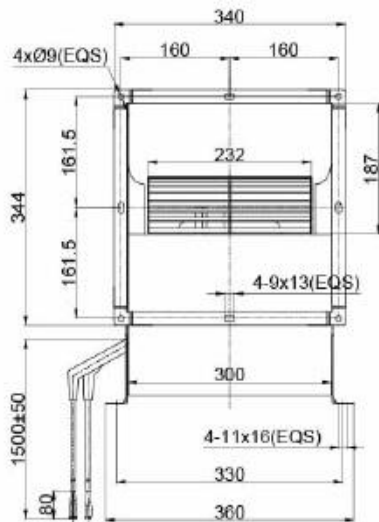

- Performance:

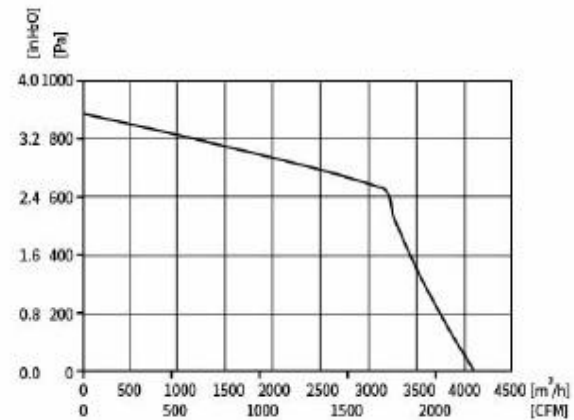

The logo for Cainton, featuring the word "CAINTON" in a bold, blue, sans-serif font. The letter "O" is replaced by a stylized gear or sunburst icon with eight segments.

Change is a perpetual motion

Phone: +886-7-215-0001

Mobile: +886-938-016696

E-mail: service@cainton.com

Address: 9F.-1, No. 171,
Bizhong St., Yancheng Dist.,
Kaohsiung City 803002, Taiwan (R.O.C.)

www.cainton.com